



Elevate Double Hung DISC LA PRE 2006

Replacement Parts

Specifications and technical data are subject to change without notice.

Numbers listed in () parentheses are metric equivalents in millimeters rounded to the nearest whole number.

Suggested fasteners are not included and must be ordered separately.

Illustrations are not to scale.

Contents

Product History.....	2
Part Identification - Operator	3
Sash Hardware	4
Miscellaneous Parts	6
Balance Tube Replacement.....	7
Aluminum Parts	8
Vinyl Parts - Discontinued No Availability (NA)	9
Wood Parts - Discontinued No Availability (NA).....	10
Weather Strip.....	11
Weather Strip: Blocks/Seals/Plugs	13
Weather Strip - Discontinued No Availability (NA)	14
Screen Replacement - Configured Part in OMS.....	15
Screen Parts	16
Screen Parts - Discontinued No Availability (NA).....	17
Sash Replacement - Configured Part in OMS	18

Produced	Unit Type	Features and Changes
1995	Double Hung	04/1995: Elevate Double Hung DISC LA PRE 2006 introduced. Unit features 3/4" Low E II glass with Argon, 4 9/16" jambs. Pultruded fiberglass (Ultrex) exterior available in white or pebble gray, almond frost sash lock and tilt latches, white or pebble gray exterior screen surround. 10/1995: Changed check rail pile weather strip (white) from location at check rail to a continuous length (gray) from check rail to sill.
1996	Double Hung	01/1996: Tempered glass added as an option to certain size double hungs and picture units. 02/1996: Vinyl trim added to the stiles of the bottom sash. Clutch system upgraded to ensure positive locking during sash removal. 10/1996: Introduced 5 5/16" and 6 13/16" jamb extension available shipped loose for field application. 11/1996: Replaced jamb weather strip profile V167 with V169 and replaced bottom sash weather strip profile V161 with foam weather strip profile V189. Replaced header hollow bulb weather strip with a parting stop.
1997	Double Hung	03/1997: Added cottage style double hung and new 5648 picture size. 09/1997: Introduced grilles-between-the-glass (GBG) simulated divided lite option.
1998	Double Hung	05/1998: Sill/jamb plug redesigned. 07/1998: Changed to a reinforced design tilt latch cover. 11/1998: Introduced white hardware and screen option
2000	Double Hung	04/2000: Added 4 wide mulling option in CN 22 and CN26 widths available factory mulled. Added 2 wide – 2 high mulling option available factory mulled. 12/ 2000: 6 13/16" jamb extension available factory applied. 5 5/16" jamb extension no longer available.
2001	Double Hung	03/2001: Added white interior finish.
2002	Double Hung	02/04/2002: Stone White replacing Arctic White as a standard color. Arctic White replacement parts available through the warranty period. 05/2002: New sizes available. Refer to Product bulletin #46. 10/2002: Revised bottom sash weather strip profile V189. Revised jamb weather strip profile V169.
2003	Double Hung	09/09/2003: Replaced sill weather strip profile V191 with V1165. Replaced bottom sash weather strip V189 with V1232. V1194 bottom jamb weather strip added in conjunction with current V169 weather strip at top. Replaced bottom sash weather strip V189 with V1232. V1194 bottom Jamb weather strip added in conjunction with current V169 weather strip at top. Effective 9/29/03.
2004	Double Hung	03/01/2004: Pebble exterior / white interior GBGs available.
2005	Double Hung	10/10/2005: Sash weather strip V1232 was removed and replaced with frame weather strip as a running change.
2006	Double Hung	01/2006: Elevate Double Hung DISC LA PRE 2006 discontinued sales and product was moved to discontinued status (Elevate Double Hung DISC LA PRE 2006 DISC LA Pre 2006).
2018	Double Hung	08/27/2018: Replacement parts have been reduced. ARCTIC WHITE NO LONGER AVAILABLE.

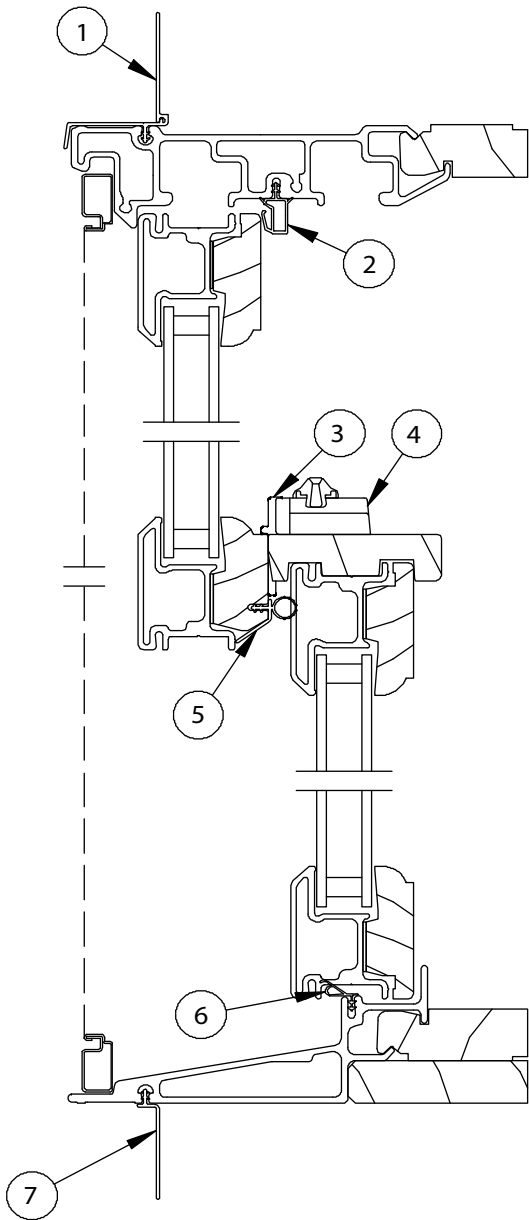

Head Jamb and Sill Detail

1. Head Jamb/Jamb Nailing Fin w/Drip Cap, V119
2. Head Jamb Parting Stop, V248
3. Sash Keeper
4. Sash Lock
5. Top Check Rail Weather Strip, V150
6. Sill Weather Strip, V191
7. Sill Nailing Fin, V104
8. Bottom Sash Weather Strip, V1232
9. Jamb Weather Strip, V169
10. Top Sash Balance Tube Assembly
11. Bottom Sash Balance Tube Assembly
12. Sash Pivot Pin

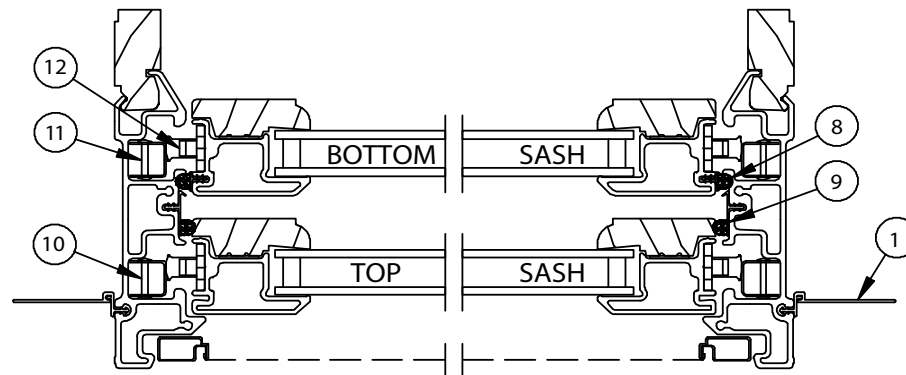

Jamb Detail

Sash Lock

Color	PN
Almond Frost	10817035
White	10817027

Suggested Fasteners	
2 – #6 x 1 1/4" Phillips flathead wood screws	
Color	PN
Almond Frost	11806001
White	11806002

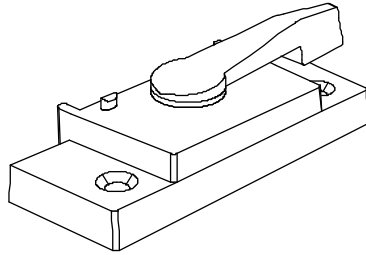

Sash Keeper

Color	PN
Almond Frost	10817036
White	10817029

Suggested Fasteners	
2 – #8 x 1" Phillips pan head screws	
Color	PN
Almond Frost	11800814
White	11800820

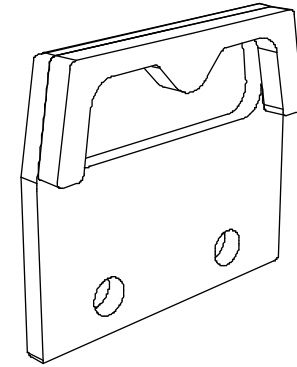

Tilt Latch Cover

Color	PN
Almond Frost	11869713
White	11869717

Suggested Fasteners	
2 – #8 x 1" Phillips pan head screws	
Color	PN
Almond Frost	11800814
White	11800820

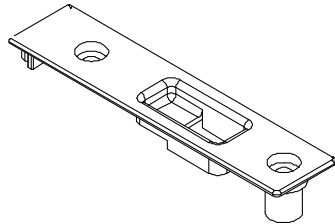

Tilt Latch

Color	LH PN	RH PN
Almond Frost	11869712	11869710
White	11869716	11869715

Suggested Fasteners	
2 – #8 x 3/4" Phillips truss head screws	
Color	PN
Almond Frost	11800833
White	11800828

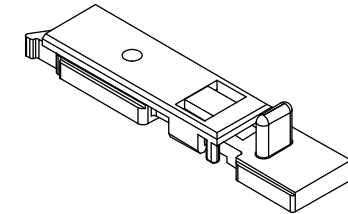

Right hand shown

Clutch

PN
10661009

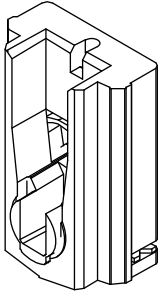

Non-handed

Sash Pivot Pin

PN
10660999

Suggested Fasteners	PN
1 – #7 x 5/8" Phillips self tapping flat head screw	11800758

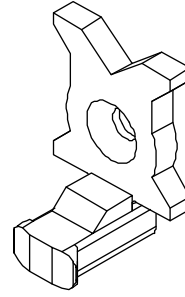

Non-handed

Stationary Bracket

PN
11040359

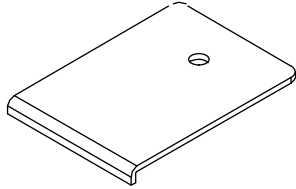

Frame to Sash Seal, Picture and Transom

Length	Color	PN
150' (46 meters)	Black	10501118

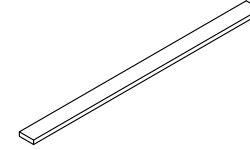

To order, provide as needed:

1. Part number
2. Quantity (Part numbers listed are for one balance tube)
3. Top or bottom sash

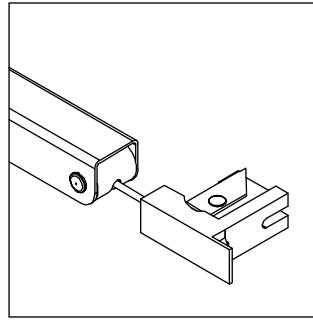

4/1995-1/1996
No longer available

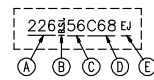
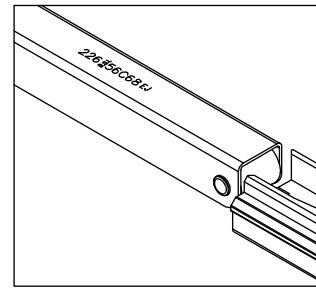

2/1996-1/2006

- a. Width of Unit
- b. Supplier Identification
- c. Height of Unit
- d. Cottage Style (if applicable)
- e. Date of Balance Tube Manufacture

Top Sash (Mill Finish)								
CN Height	22-26 CN Width		30-34 CN Width		36-38 CN Width		42 CN Width	
	No. Stamped on Tube	PN	No. Stamped on Tube	PN	No. Stamped on Tube	PN	No. Stamped on Tube	PN
36	226-36	10661036	304-36	10662036	368-36	10663036	42-36	10664036
40	226-40	10661040	304-40	10662040	368-40	10663040	42-40	10664040
48	226-48	10661048	304-48	10662048	368-48	10663048	42-48	10664048
52	226-52	10661052	304-52	10662052	368-52	10663052	42-52	10664052
56C68	226-56C68	10661056	304-56	10662056	368-56	10663056	42-56C68	10664056
60	226-60	10661060	304-60	10662060	368-60	10663060	42-60	10664060
64	226-64	10661064	304-64	10662064	368-64	10663064	42-64	10664064
72	226-72	10661072	304-72	10662072	368-72	10663072	42-72	10664072

Bottom Sash (Beige Finish)								
CN Height	22-26 CN Width		30-34 CN Width		36-38 CN Width		42 CN Width	
	No. Stamped on Tube	PN	No. Stamped on Tube	PN	No. Stamped on Tube	PN	No. Stamped on Tube	PN
36	226-36	10661136	304-36	10662136	368-36	10663136	42-36	10664136
40	226-40	10661140	304-40	10662140	368-40	10663140	42-40	10664140
48	226-48	10661148	304-48	10662148	368-48	10663148	42-48	10664148
52	226-52	10661152	304-52	10662152	368-52	10663152	42-52	10664152
56	226-56	10661156	304-56	10662156	368-56	10663156	42-56	10664156
60	226-60	10661160	304-60	10662160	368-60	10663160	42-60	10664160
64	226-64	10661164	304-64	10662164	368-64	10663164	42-64	10664164
72C68	226-72C68	10661172	304-72	10662172	368-72	10663172	42-72C68	10664172

Sill Filler

A441

CN	Length	Stone White PN	Pebble Gray PN
22	19 3/16" (487)	19611422	18611522
26	23 3/16" (589)	19611426	18611526
30	27 3/16" (691)	19611430	18611530
34	31 3/16" (792)	19611434	18611534
36	33 3/16" (843)	19611436	18611536
38	35 3/16" (894)	19611438	18611538
42	39 3/16" (995)	19611442	18611542
50	47 3/16" (1199)	19611450	18611550
54	51 3/16" (1300)	19611454	18611554
62	59 3/16" (1503)	19611462	18611562

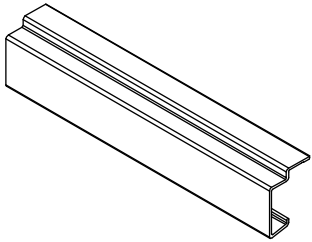

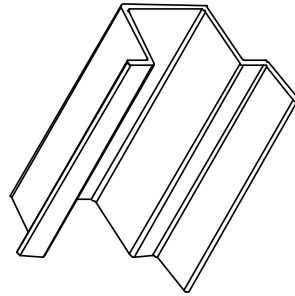

Sash Stop, V820

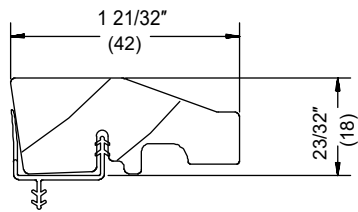

Interior Stop, Head Jamb, W7430

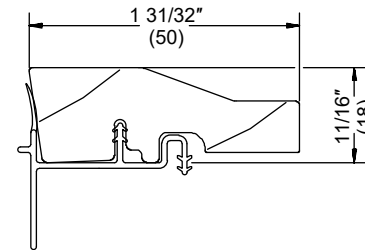

Interior Stop, Sill, W7429

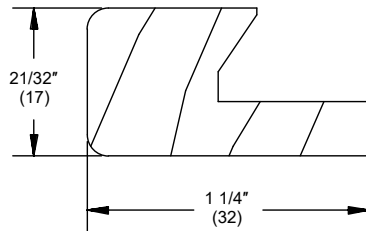

**HP Field Applied Sill Liner
Picture/Transom, W8586**

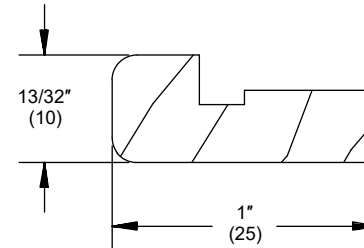

**HP Field Applied Sill Liner
Operator, W8088**

Jamb Weather Strip

V169

CN	Length	Color	PN
Lineal	79" (2007)	Beige	17002982

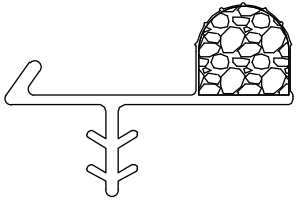

Head Jamb Parting Stop

V248

CN	Length	Color	PN
Lineal	84" (2134)	Beige	17003184

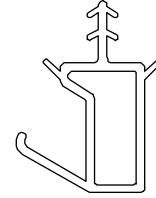

Sill Weather Strip

V1165

CN	Length	Beige PN
42	40 3/8" (1026)	17003642
Lineal	150" (3810)	17003699

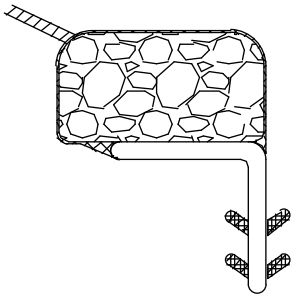

Check Rail Weather Strip

V150

CN	Length	Beige PN
42	39 1/8" (994)	17001842

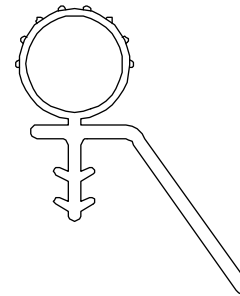

Head Jamb Weather Strip

V1165

For Double Hung Picture and Transom Units

CN	Length	Beige PN
Lineal	144" (3658)	17002399

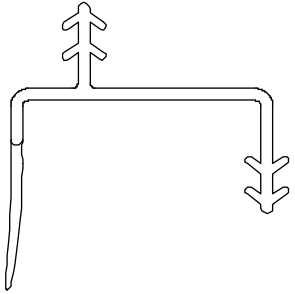

Sill Interior Stop Weather Strip

V150

For Double Hung Picture and Transom Units

CN	Length	Beige PN
Lineal	144" (3658)	17002499

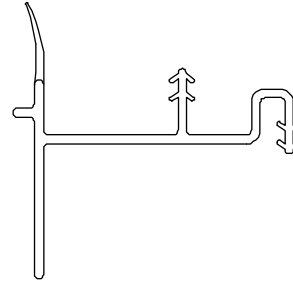

Sash Pivot Pin Pad

5/16" x 11/16"

NOTE: Adhesive backed

PN
15607568

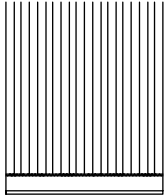

Frame Weather Strip, Pile

V1494

CN	Color	PN
Specify LF	Beige	17009012

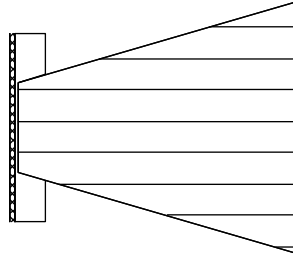

Check Rail Dust Block

1 1/4" x 1/2"

NOTE: Adhesive backed

Color	PN
Gray	15608565



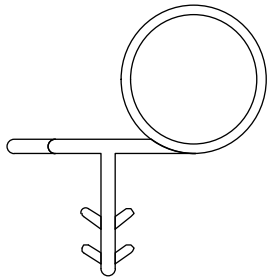

**Double Hung Head Jamb
Weather Strip, V192**
Used 4/95 - 11/96
Replace with V248

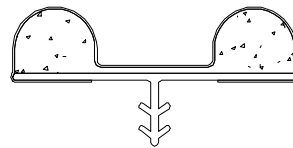

**Double Hung Head Jamb
Weather Strip, V192**
Replace with V169

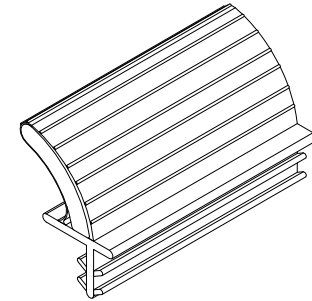

Bottom Jamb Weather Strip, V1194

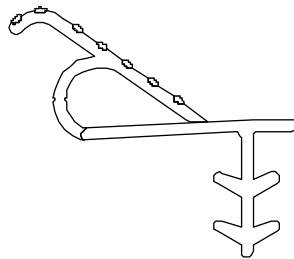

Sill Weather Strip, V191
Used 4/95 - 9/03
Replace with V1165

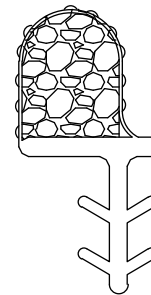

Bottom Sash Foam Weather Strip, V1232
Replace with V1452 (Essential series part)

Ordering specifications (use all that apply):

1. Use existing screen OM to order
2. Size: Determine the outside measurement of the existing screen and find the sizes that correspond to the width and height indicated in the following charts. If there is no existing screen to determine the OM of the screen, use the Daylight Opening to OM of screen conversions shown in the chart. The daylight opening is the measurement of visible glass from the interior of the unit;
3. Color
4. Specify cottage or equal sash when ordering CN68 height

Screens are standard with a white or pebble gray aluminum surround. Standard mesh is Marvin Bright View™. Screens feature plunger type mounting system.

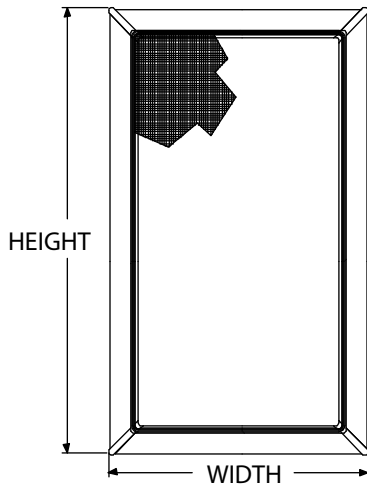

NOTE: Measure top and bottom sash separately when calculating screen OM height. CN36 and CN40 screens do not feature cross bars.

NOTE: OM of screen includes corner keys.

Screen sizes for Elevate Double Hung DISC LA PRE 2006 Manufactured 1995 to January 2006

Daylight Opening to OM of Screen

Daylight width + 4 9/16" = OM width of screen

Daylight height x 2 + 7 19/32" = OM height

CN Size	OM Width
22	20 1/4" (514)
26	24 1/4" (616)
30	28 1/4" (718)
34	32 1/4" (819)
36	34 1/4" (870)
38	36 1/4" (921)
42	40 1/4" (1022)

CN Size	OM Height
36	34 31/32" (888)
40	38 31/32" (990)
48	46 31/32" (1193)
52	50 31/32" (1295)
56	54 31/32" (1396)
60	58 31/32" (1498)
64	62 31/32" (1599)
68	66 31/32" (1701)
72	70 31/32" (1803)

Plunger and Spring Assembly

Includes:

- 1 - Plunger bolt
- 1 - Plunger cap
- 1 - Plunger spring

PN
11851059

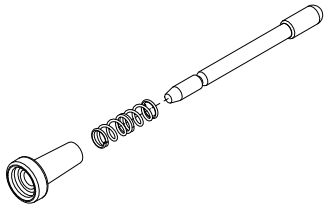

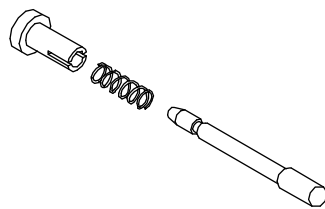

Plunger and Spring Assembly

Clear cap, Off White bolt

Replace with current.

Ordering specifications (use all that apply):

1. Top, bottom, or pair of sash
2. Size (use charts below)
3. Sash exterior color;
4. Interior finish or bare wood
5. Hardware color - White or Almond Frost
6. Glazing

Top Sash Interior View

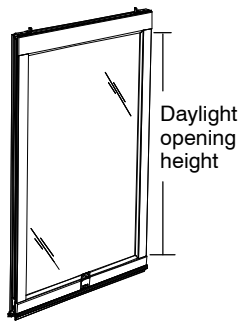

Bottom Sash Interior View

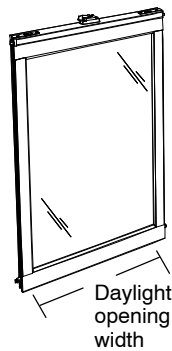

NOTE: Replacement sash is supplied with weather strip and hardware. Double Hung Picture replacement sash includes attached sill filler. Daylight opening is the measurement of visible glass from the interior. CN68 height pertains to cottage style sash.

NOTE: Sash is not reglazable; glass replacement will require a new sash

Sash sizes for Elevate Double Hung manufactured 1995 to January 2006

Daylight Opening to OM of sash

Daylight width + 3 1/2" = OM width of sash

Daylight height + 3 1/2" = OM height of sash

Operator Sash Measurements	
CN Size	OM Width
22	19 3/16" (487)
26	23 3/16" (589)
30	27 3/16" (691)
34	31 3/16" (792)
36	33 3/16" (843)
38	35 3/16" (894)
42	39 3/16" (995)
CN Size	OM Height
36	17 3/16" (437)
40	19 3/16" (487)
48	23 3/16" (589)
52	25 3/16" (640)
56	27 3/16" (691)
60	29 3/16" (741)
64	31 3/16" (792)
68 (top)	27 3/16" (691)
68 (btm)	39 3/16" (995)
72	35 3/16" (894)

Picture/Transom Sash Measurements	
CN Size	OM Width
22*	19 3/16" (487)
26*	23 3/16" (589)
30*	27 3/16" (691)
34*	31 3/16" (792)
36*	33 3/16" (843)
38	35 3/16" (894)
42	39 3/16" (988)
50	47 3/16" (1199)
54	51 3/16" (1300)
62	59 3/16" (1503)
CN Size	OM Height
16*	13 3/16" (335)
48	45 3/16" (1148)
52	49 3/16" (1249)
56	53 3/16" (1351)
60	57 3/16" (1453)
64	61 3/16" (1554)
68	65 3/16" (1656)
*Transom sizes only	