

Please load correctly to access the standard sizes contained in the TXT file (From open project, Insert tab/Load Family). Refer to the Architectural Detail Manual document for a listing of standard sizes

### Bi-fold Door Families: Panel Configuration

- The number of panels needed must be correct when the family is loaded but the configuration can be changed after the door is in your project
- Options are listed in Properties/Construction
- Please refer to the Configurations images at the end of this document \*
- Example: When the UBFLD15080-6P is loaded, the default configuration is Option 15 (3L3R). To change that to 6L0R, the Option Choice\_Configuration parameter will need to be changed to 16

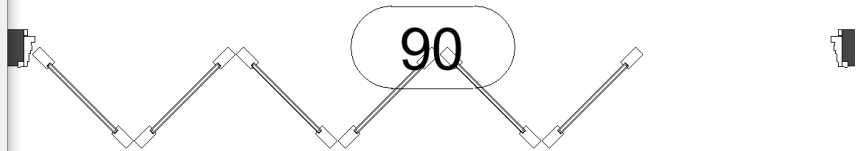
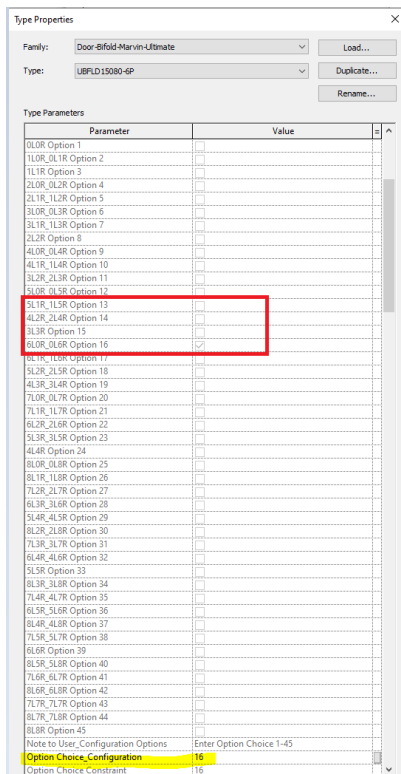

- If the unequal sided panels are opening the wrong direction, use the Swing Reverse LH\_RH parameter

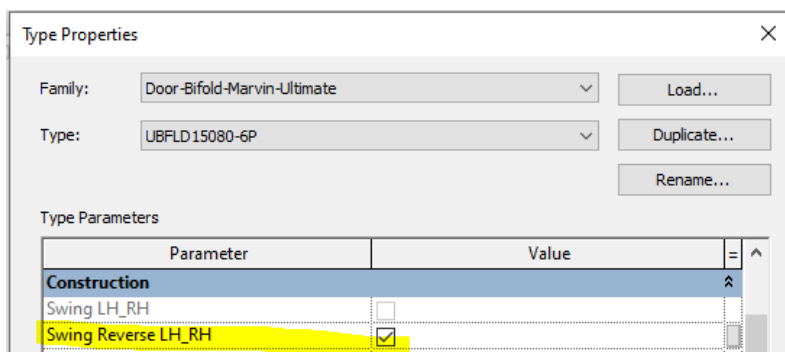

### Bifold Door Families: Screen

- There are two interior retractable screen options: unidirectional and bi-parting
- Changes to the screen can be made in the Graphics portion of the Type Properties
- Uncheck the Screen Visibility parameter if no screen is needed
- If using the screen, please note the maximum allowable sizes of each screen listed in gray

The screenshot shows the 'Type Properties' dialog box for the 'Door-Bifold-Marvin-Ultimate' family. The 'Type' is set to 'UBFLD15080-6P'. The 'Graphics' section is expanded, showing a list of parameters and their values. A red box highlights the 'Screen' parameters.

Parameter	Value
<b>Graphics</b>	
Jamb Extension Visibility	<input checked="" type="checkbox"/>
Jamb Extension Constraint	<input type="checkbox"/>
Elevation Swing Visibility	<input checked="" type="checkbox"/>
Muntins Visibility	<input checked="" type="checkbox"/>
Label Visibility	<input type="checkbox"/>
Casing Visibility	<input checked="" type="checkbox"/>
BMC	<input checked="" type="checkbox"/>
Flat Casing	<input type="checkbox"/>
Screen Visibility	<input checked="" type="checkbox"/>
Screen Uni_Directional	<input type="checkbox"/>
Screen Bi_Parting	<input checked="" type="checkbox"/>
Screen Uni_Directional MaxWidth	12' 8 69/256"
Screen Bi_Parting MaxWidth	24' 8 69/256"
Screen MaxHeight	10' 5 5/32"

### Bi-fold Door Families: Bottom Rail

- This door has a taller bottom rail option (8 1/8" versus 4 3/4") for a more traditional look
- Check the 8.125" Bottom Rail parameter (Type Properties: Construction) for this option

Type Properties

Family: Door-Bifold-Marvin-Ultimate Load...

Type: UBFLD15080-6P Duplicate... Rename...

Type Parameters

Parameter	Value
<b>Constraints</b>	
Prairie Corner Width	0' 4"
Prairie Corner Height	0' 4"
Lites Wide	3
Lites High	5
Lite Cut Prairie 9	<input type="checkbox"/>
Lite Cut HV Grid	<input checked="" type="checkbox"/>
<b>Construction</b>	
Swing LH_RH	<input type="checkbox"/>
Swing Reverse LH_RH	<input checked="" type="checkbox"/>
Standard Bottom Rail	<input checked="" type="checkbox"/>
8.125" Bottom Rail	<input type="checkbox"/>

#### Bifold Door Families: Sill Options

- Also a Construction Type Property parameter
- Change the Option Choice\_Sill parameter for either the Low Profile Sill or the Floor Channel Sill

Type Properties

Family: Door-Bifold-Marvin-Ultimate Load...

Type: UBFLD15080-6P Duplicate... Rename...

Type Parameters

Parameter	Value
Performance Sill Option 1	<input checked="" type="checkbox"/>
Low Profile Sill Option 2	<input type="checkbox"/>
Floor Channel Sill Option 3	<input type="checkbox"/>
Note to User_Sill Options	Enter Option Choice 1-3
Option Choice_Sill	1

## Bi-Parting (Unequal) Units

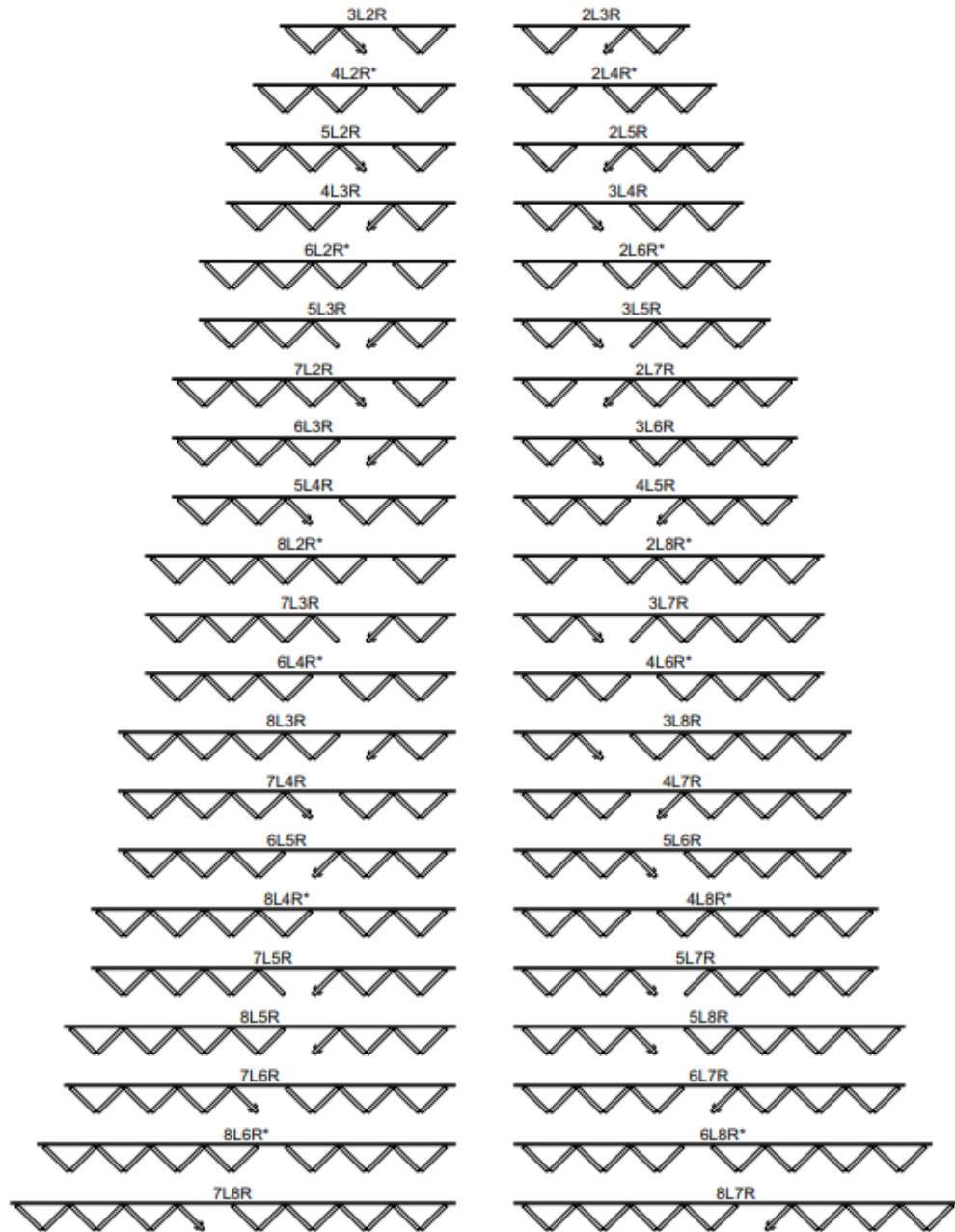

\* Not accessible from the exterior.

## Stationary Unit

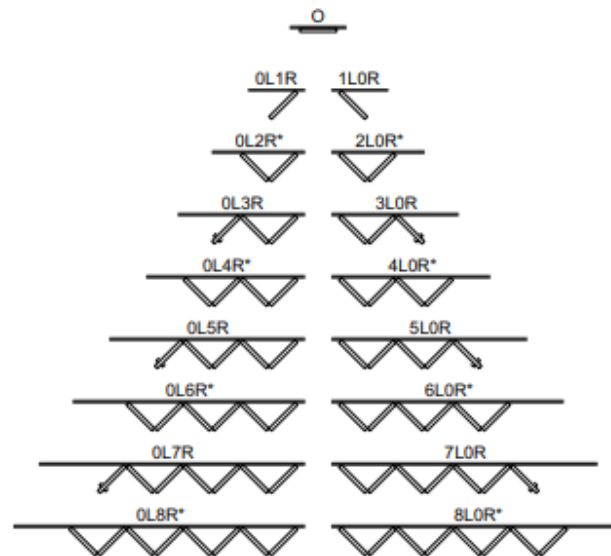

## Uni-directional Left or Right Units

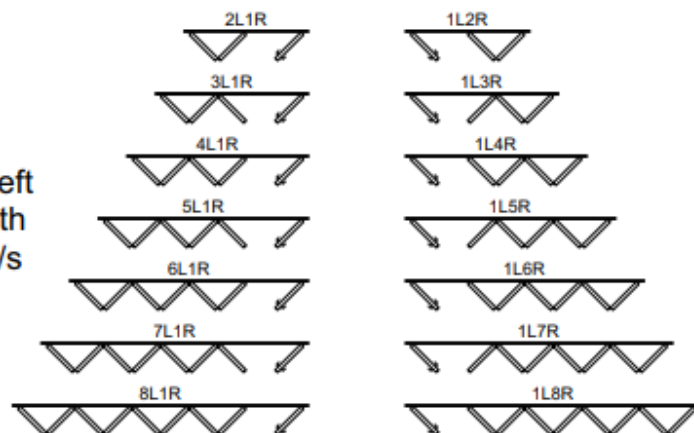

## Uni-directional Left or Right Units with Operating Panel/s

## Bi-parting (equal) Units

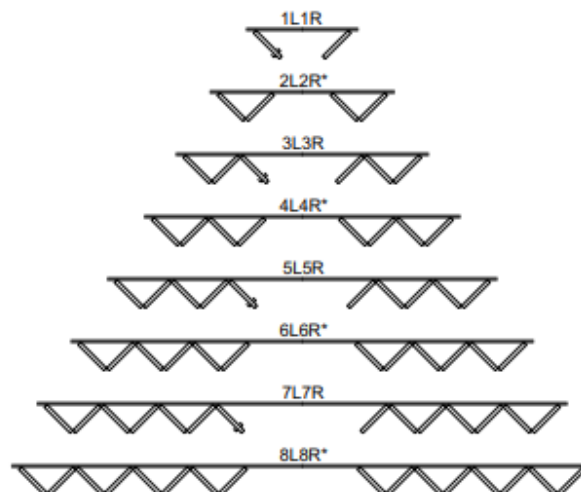

\* Not accessible from the exterior.

