



Ultimate and Ultimate Wood Double Hung Magnum Tilt Pac

Replacement Parts

Specifications and technical data are subject to change without notice.

Numbers listed in () parentheses are metric equivalents in millimeters rounded to the nearest whole number.

Suggested fasteners are not included and must be ordered separately.

Illustrations are not to scale.

Contents

Product History.....	2
Miscellaneous Parts	3
Weather Strip	6

Produced	Features and Changes
1985	Introduced Double Hung Magnum Tilt Pac. Replacement kit contains: 1 3/4" sash, beige vinyl jamb liners, dual balance system and sash brackets.
1986	Introduced Historical Double Hung Magnum Tilt Pac. Unit features historic profile muntin and bars, 1 3/4" sash, routed finger pulls, dual balance system, white vinyl jamb liners, white cam lock and (optional) white interior energy panel. Unit features 1 3/4" sash, dual balance system and beige vinyl jamb liners.
1989	Unit features 1 3/4" sash, beige vinyl jamb liners and dual balance system. Aluminum clad exterior available in bronze, white and pebble gray.
1992	Simulated divided lite introduced.
1993	Sash lock changed to spring loaded sash lock.
1994	Interior energy panel surround changed from vinyl to metal. Energy panel fastening clip changed from butterfly clip to push/pull panel clip.
2002	3/02 Stone White becomes a standard color. Arctic White transitions to a select color.
2003	3/31/03 Satin Taupe hardware replaces Bronze as standard.
2008	6/02/2008 Introduced charcoal colored high transparency screen mesh (CH HI-TRAN) as an option on all window and door products (including combinations).
2009	3/23/2009 Added LoE3-366 as a standard option for all products. Added Cedro Macho as a standard option for all Ultimate products.
2011	4/25/2011 Added LoE-180TM as a standard option for all products. White painted interior finish option introduced.
2012	4/30/2012 Introduced a new screen design as standard. 10/29/2012 Interior Square Sticking/Glazing Bead option introduced. 12/17/2012 Introduced Clear interior finish option on all products.
2013	4/29/2013 Introduced interior stain options. Stain colors are Wheat, Honey, Leather, Hazelnut, Cabernet and Espresso.
2016	10/31/2016 Obsolescence of the wood species Cedro Macho for all products.
2017	10/30/2017 Discontinued EP colors with exception of Stone White and Bronze.
2020	4/27/2020 Discontinued (DISC NA) combination colors with the exception of Stone White and Bronze.
2021	8/30/2021 The Ultimate and Ultimate Wood Double Hung and Single Hung Magnum Tilt Pac product line was DISC-NA (No Longer Available). With the exclusion of sash replacement (DISC-NA), all replacement parts in this section will be DISC-LA (Limited Availability) unless otherwise noted. See Product Bulletins 771, 782 and 783 for more information.

Sash Lock

Includes:

- 1 - Sash lock
- 2 - #7 x 7/8" Phillips flat head wood screw

Color	PN
Satin Taupe	10818034
Bronze	10818033
White	10840026
Brass	05600082
Antique Brass	05600084
Polished Chrome	05600086
Satin Chrome	05600088
Oil Rubbed Bronze	05600090
Satin Nickel	05600092

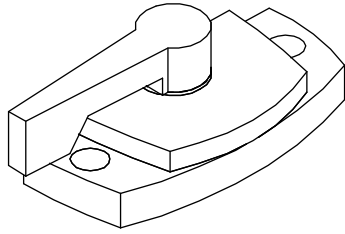

Keeper

Includes:

- 1 - Keeper
- 2 - #7 x 7/8" Phillips flat head wood screw

Color	PN
Satin Taupe	10818052
Bronze	10818051
White	10818050
Brass	10818053
Antique Brass	10818054
Polished Chrome	10818055
Satin Chrome	10818056
Oil Rubbed Bronze	10818057
Satin Nickel	10818058

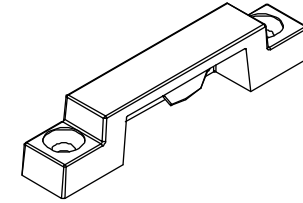

Historic Sash Lock

Includes:

- 1 - Sash lock
- 2 - #6 x 1" Phillips flat head wood screw

Color	PN
White	10840013

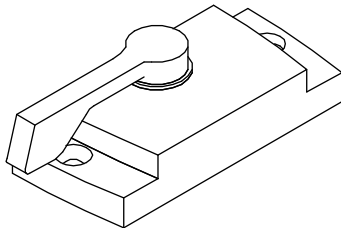

Keeper, Historic

Includes:

- 1 - Keeper
- 2 - #6 x 1" Phillips flat head wood screw

Color	PN
White	10840014

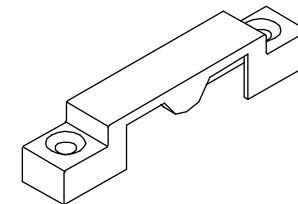

Sash Lift

Includes:

- 1 - Sash lift
- 2 - #8 x 1" slotted oval head sheet metal screws

Color	PN
Satin Taupe	10500598
Bronze	10500557
White	10500556
Brass	10500558
Antique Brass	10500597
Polished Chrome	10500595
Satin Chrome	10500596
Oil Rubbed Bronze	10500601
Satin Nickel	10500602

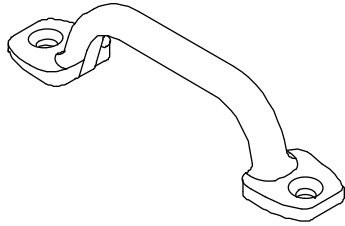

Installation Clip, Jamb Liner

1" x 4 1/4"

PN
11860010

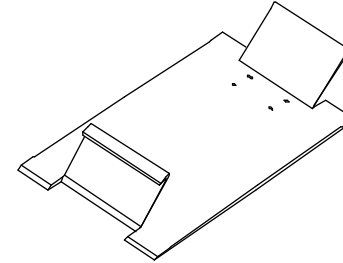

Locking Terminal

PN
11870460

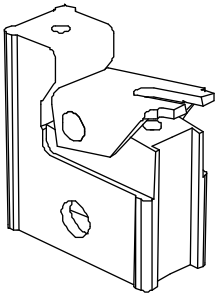

Jamb Liner Foam

9/16" x 1 7/16", with PVC edge

Length	PN
Specify length	10500014

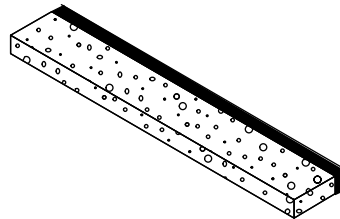

Jamb Liner Foam (Single Hung)

7/16" x 2 3/4", with PVC edge

Length	PN
Specify length	10500008

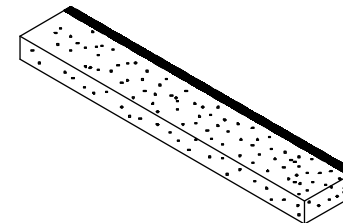

Foam Plug (Chimney Block)

1" x 9/16" x 3/4"

Located at the bottom of the vinyl jamb liner

PN
10500205

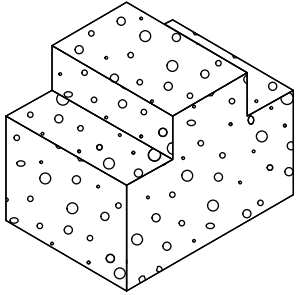

Foam Gasket

PN
10500100

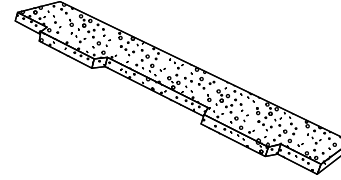

Fin Seal Pad

Color	PN
White	10500223

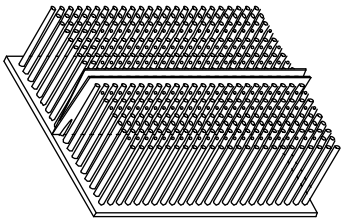

Bulb Weather Strip, Bottom Rail

V192

Color	Length	PN
Beige	84" (2134)	15900058

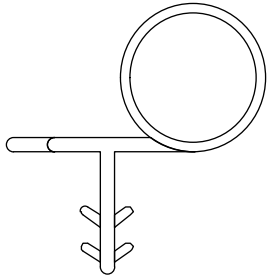

Dual Seal Weather Strip, Check Rail

V116

Color	Length	PN
White	84" (2134)	15828400

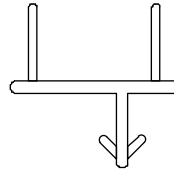

Hinged Leaf Weather Strip, Parting Stop

V245

Color	Length	PN
White	84" (2134)	15818400

