



Elevate Direct Glaze Polygon

Replacement Parts

Specifications and technical data are subject to change without notice.

Numbers listed in () parentheses are metric equivalents in millimeters rounded to the nearest whole number.

Suggested fasteners are not included and must be ordered separately.

Illustrations are not to scale.

Contents

Product History.....	2
Part Identification - Direct Glaze Polygon (Casement).....	4
Part Identification - Direct Glaze Polygon (DH, Glider and Door)	5
Polygon Shapes Replacement Glass	6
Glass Replacement Parts	7
Glass Replacement Parts - Discontinued Limited Availability (LA)	8

Produced	Unit Type	Features and Changes
1997	Direct Glaze Transom for all products	09/1997: Unit features direct glazed 3/4" Low E II glass with Argon, 4 9/16" jambs, pultruded fiberglass (Ultrex) exterior available in white or pebble gray, available in 7316 for the Casement 3-wide unit (25-3w) and 7316 for the Elevate Patio Door (6068). The 7316 is available factory or field mulled to the Elevate Patio Door. White grilles-between-the-glass (GBG) simulated divided lite option is available for 7316 and 3716.
1999	Direct Glaze Polygon	03/1999: Unit features direct glazed 3/4" Low E II glass with Argon, 4 9/16" jambs, Pultruded fiberglass (Ultrex) exterior available in white or pebble gray. Units are available for Elevate Casement/Awning, Glider, Double Hung and Patio Door products. 11/1999: V119 nailing fin (with drip cap) changed to V104 nailing fin (with drip cap removed) on all polygons except rectangular shapes.
2000	Direct Glaze Rectangle	04/2000: Introduced white grilles-between-the-glass (GBG) simulated divided lite option. Cuts limited to equal sized rectangular lites and a minimum 4 1/2" daylight opening. Added a 4 wide and 2 wide 2 high mulling option available factory mulled. 12/2000: 6 13/16" jamb extension available factory applied. 5 5/16" jamb extension no longer available.
2001	Direct Glaze Polygon	03/2001: Added white interior finish.
2002	Direct Glaze Polygon	02/04/2001: Stone White replacing Arctic White as a standard color effective Feb. 4, 2002. Arctic White replacement parts available through the warranty period.
2004	Direct Glaze Polygon	03/2004: Pebble exterior / White interior GBGs available 3/1/04. Standard 6-0 door width changed from 73 opening to 72 opening. 3616 and 7216 sizes added for Polygons. Standard 6-0 door width changed from 73 opening to 72 opening. 3616 and 7216 sizes added for Polygons. 36-2W and 7218 elliptical added for Round Tops effective 3/1/04.
2005	Direct Glaze Polygon and Transom	01/2005: Added Elevate Inswing French Door 108 and Elevate Sliding French Door and Elevate Sliding Patio Door 107 Direct Glaze widths to be mulled over 3-wide doors.
2006	Direct Glaze Polygon and Transom	07/2006: SDL offered on all Elevate Series windows and doors. 7/8" wide bars with Ultrex exterior and wood interior (Product Bulletin 66). 09/2006: Prairie SDL and GBG Lite cuts made available for the Elevate Series windows and doors (Product Bulletin 70).
2007	Direct Glaze Polygon and Transom	03/2007: Bronze exteriors introduced. 11/2007: Evergreen exteriors introduced.
2008	Direct Glaze Polygon and Transom	03/17/2008: Cashmere exteriors introduced March 17, 2008. 07/2008: Cottage SDL lite cut made available for Elevate (Product Bulletin 99).
2010	Direct Glaze	04/2010: Introduced tempered obscure glass. 06/2010: Introduced SDL Spacer Bar Glass option on LoE3 366®
2011	Direct Glaze Polygon and Transom	04/2011: LoE 180 glass option introduced.
2012	Direct Glaze Polygon and Transom	04/2012: Introduced the SDL Spacer Bar glass option on LoE2 272® and LoE 180. Simulated Check Rail Bar option introduced (Polygon). 08/27/2012: Ebony exteriors were introduced for Elevate products
2013	Direct Glaze Polygon and Rectangle	02/05/2013: Introduced Tripane glass option utilizing a Casement frame.
2014	Direct Glaze Polygon	08/25/2014: Introduced bronze as a standard interior GBG color option for all Elevate products that currently get GBG. Available in all lite cut patterns currently offered in standard and special sizes.
2017	Direct Glaze Polygon	12/18/2017: Added availability of customer specified lite cut configurations for SDL with and with out spacer bar and GBG. To include simulated check rail and any color GBG to the exterior only of standard and special sized units.
2018	Direct Glaze Polygon	12/17/2018: Introduced textured glass types: Reed, Narrow Reed, Rain, Glue Chip and Frost and also colored glass types: Clear, Bronze, Gray and Green.
2022	Direct Glaze Polygon and Rectangle	04/25/2022: Discontinued the Direct Glaze Transom products, call numbers and part numbers. Direct Glaze Transom is identical to Direct Glaze Rectangle and all current sizes of Transom are available as Direct Glaze Rectangle. See Product Bulletin 826 for more details. 10/31/2022: Discontinued Evergreen exterior. See Product Bulletin 851 for more details.

2023	Direct Glaze Polygon and Rectangle	02/27/2023: Gunmetal introduced. See Product Bulletin 863 for more details. 06/26/2023: Glazing stops changed from W4160 to W13981. See Product Bulletin 892 for more information. 10/30/2023: An ERS coating became available as a standard option for current Triple Pane offerings. Low E3 was also added as a glass option to Triple Pane. See Product Bulletin 904 for more details.
------	------------------------------------	---

Casement

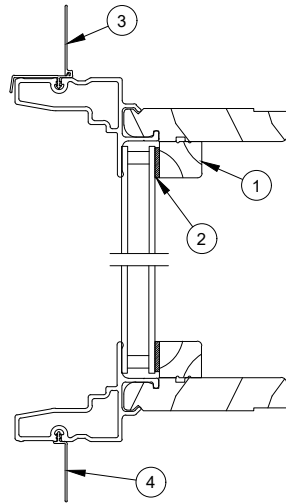

Head Jamb and Sill Detail

1. Glazing Bead, W13981
2. Glazing Tape
3. Head Jamb Nailing Fin/Drip Cap, V1119
4. Sill Nailing Fin, V084
5. Jamb Nailing Fin, V104

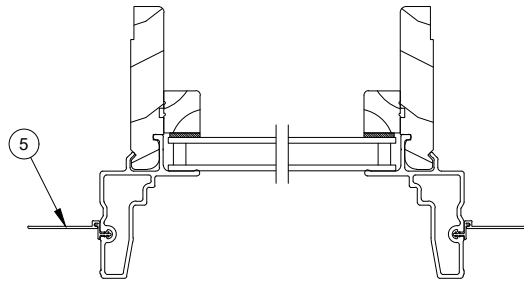

Jamb Detail

Double Hung, Glider and Door

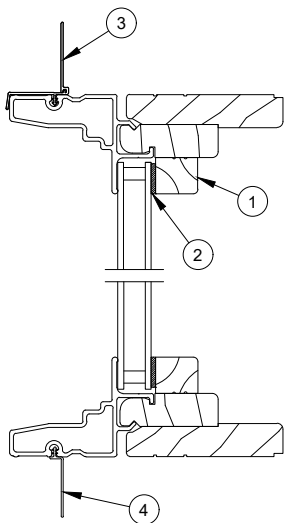

Head Jamb and Sill Detail

- 1. Glazing Bead, W13981
- 2. Glazing Tape
- 3. Head Jamb Nailing Fing/Drip Cap, V1119
- 4. Sill Nailing Fin, V084
- 5. Jamb Nailing Fin, V104

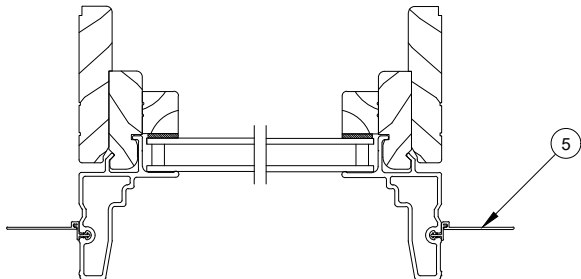

Jamb Detail

When ordering, specify:

1. Original order/line number
2. Shape
3. Rough opening* (polygon shapes only)
4. Glazing

NOTE: W13981 Glazing bead (6/5/2023) to present) is included when ordering replacement glass for Direct Glaze Polygon.

*If rough opening is not available, provide the exterior daylight opening by measuring at key dimensions shown in the shape chart below and contact your Marvin representative to calculate rough opening.

Conversion for Rectangle Units Only

Determine the rough opening of the existing direct glaze rectangle by measuring the daylight opening. The daylight opening is a measurement of the visible glass.

Daylight opening width (DLO) + 5 3/8" (137) = Rough Opening width.
Daylight opening height (DLO)+ 4 7/8" (124) = Rough Opening height.

NOTE: Daylight opening measurement is from the interior.

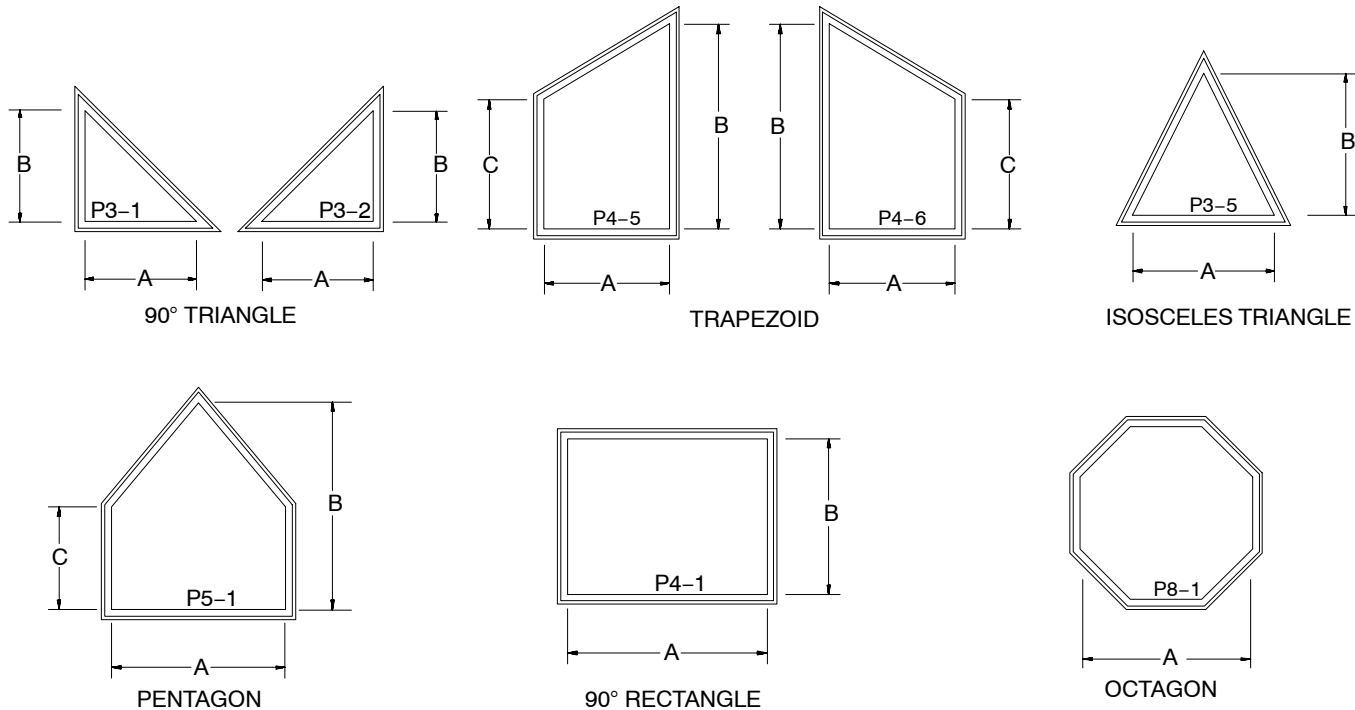

NOTE: Exterior view shown

Glazing Bead - Lineal

W13981

Usage Dates:

6/5/2023 to present

Size	Finish and Part Number			
	Bare Wood	White	Designer Black	Clear
73" (1854)	32181073	39201073	39932072	33830073
96" (2438)	32181097	39201097	39932097	33830097
120" (3048)	32181121	39201120	39932121	33830121
144" (3658)	32181144	39201144	39932144	33830144

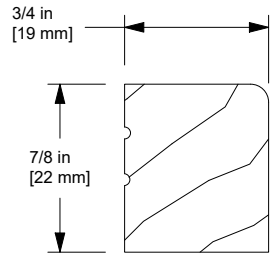

Glazing Tape

3/32" x 5/8"

NOTE: 2-sided adhesive foam tape

Length	PN
96" (2438)	11406227
100' (30 meters)	11406226

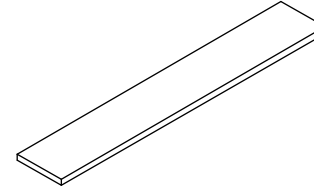

Glazing Bead - Lineal

W4160

Usage dates:

Prior to 6/5/2023

Size	Finish and Part Number			
	Bare Wood	White	Designer Black	Clear
120" (3048)	32181298	39201798	39931298	33831298

