

Tilt Latch Replacement

Field Applied Instructions – Essential Single Hung



INCLUDED IN PACKAGE:

2 – Tilt Latches (LH and RH)

1. Use a small flat bladed screwdriver to remove the old tilt latch by prying the tabs on the flexible leg from the channel on the sash stile. See figure 1.



Figure 1: Remove old tilt latch with a screwdriver.

YOU WILL NEED:

- Small flat bladed screwdriver

2. Insert the new tilt latch into the sash with the beveled side toward the window. Insert the tabs on the flexible leg into the groove on the sash stile. See figure 2.

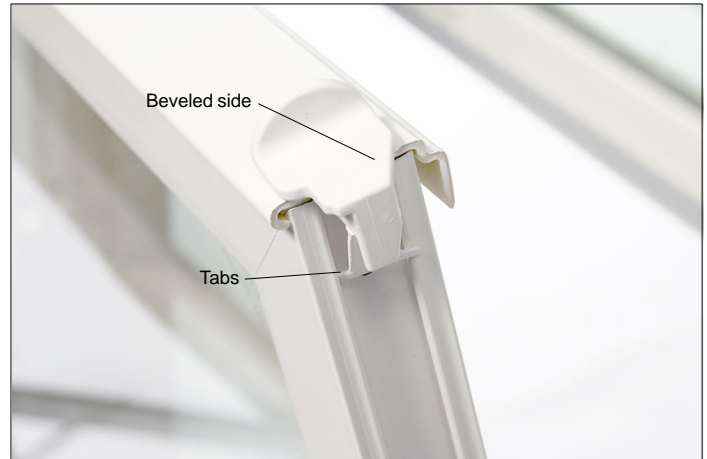

Figure 2: Insert new latch with beveled edge toward window.

19970251
07/29/2019

Tilt Latch Replacement

Field Applied Instructions – Essential Single Hung



INCLUDED IN PACKAGE:

2 – Tilt Latches (LH and RH)

1. Use a small flat bladed screwdriver to remove the old tilt latch by prying the tabs on the flexible leg from the channel on the sash stile. See figure 1.

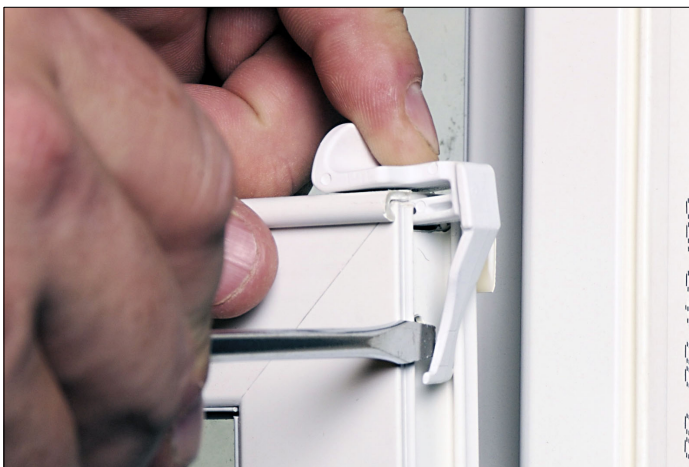

Figure 1: Remove old tilt latch with a screwdriver.

YOU WILL NEED:

- Small flat bladed screwdriver

2. Insert the new tilt latch into the sash with the beveled side toward the window. Insert the tabs on the flexible leg into the groove on the sash stile. See figure 2.

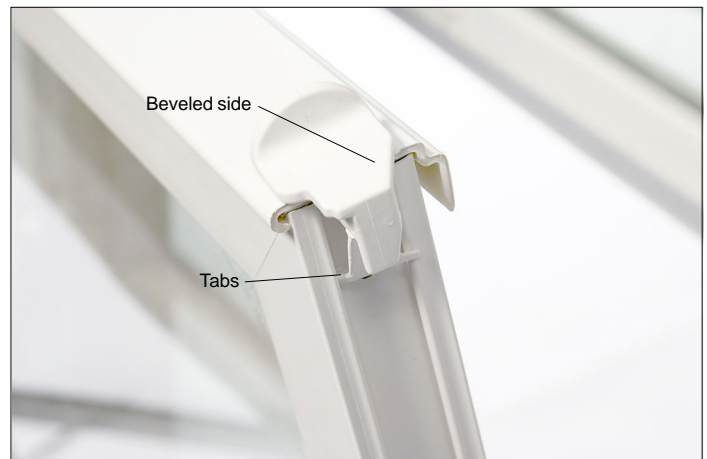

Figure 2: Insert new latch with beveled edge toward window.

19970251
07/29/2019