



Modern MultiSlide Door

Replacement Parts

Specifications and technical data are subject to change without notice.

Numbers listed in () parentheses are metric equivalents in millimeters rounded to the nearest whole number.

Suggested fasteners are not included and must be ordered separately.

Illustrations are not to scale.

Contents

| | |
|---|----|
| Product History..... | 2 |
| Part Identification - Pocket/Stacked Head Jamb and Sill Details | 3 |
| Part Identification - Stacked Jamb Details..... | 4 |
| Part Identification - Pocket Jamb Details..... | 5 |
| Replacement Panels and Sills | 6 |
| Installation Parts..... | 7 |
| Installation Kit Parts - Uni-Directional Stacked Kit..... | 11 |
| Installation Kit Parts - Uni-Directional Pocket Kit..... | 12 |
| Installation Kit Parts - Bi-Parting Stacked Kit..... | 13 |
| Installation Kit Parts - Bi-Parting Pocket Kit | 14 |
| Handles | 15 |
| Operators..... | 16 |
| Locking Hardware..... | 17 |
| Lock Status Sensor Parts..... | 19 |
| Automatic Control Parts | 20 |
| Automatic Control Parts - Locally Sourced..... | 25 |
| Miscellaneous Parts | 26 |
| Miscellaneous Parts - Discontinued No Availability (NA)..... | 33 |
| Aluminum Parts | 34 |
| Aluminum Parts - Fabricated..... | 37 |
| Vinyl Parts..... | 41 |
| Vinyl Parts - Fabricated | 43 |
| Vinyl Parts - Discontinued No Availability (NA) | 44 |
| Weather Strip..... | 45 |
| Screen Handing Diagram..... | 46 |
| Retractable Screen SE4 Parts Configured Parts in OMS..... | 47 |
| Retractable Screen SE4 Parts..... | 48 |
| Scenic Door Sliding Screen Parts - Disc LA Pre 4/27/20 | 52 |

| Produced | Unit Type | Features and Changes |
|----------|------------------------|--|
| 2018 | Modern MultiSlide Door | 10/29/2018: Introduced the Modern MultiSlide Door. |
| 2019 | Modern MultiSlide Door | 4/29/2019: Added Stone White Hardware, Exterior Jamb/Head Jamb cover F2065 was replaced with A3476. |
| 2020 | Modern MultiSlide Door | 4/27/2020: Scenic Door Modern Sliding Screen transitions to the SE4 Retractable Screen. |
| 2021 | Modern MultiSlide Door | 12/13/2021: A new Sliding Door Automatic Control (SDAC) system will be available on Ultimate and Modern multi-slide door products with the OMS version 3.12 on December 13, 2021. See Product Bulletin #805 for more information and Product Bulletin #837 for installation requirements. |
| 2023 | Modern MultiSlide Door | 10/30/2023: An ERS coating became available as a standard option for current Triple Pane offerings. See Product Bulletin 904 for more details. |
| 2024 | Modern MultiSlide Door | <p>2/26/2024: Additional 2-track configurations became available. See Product Bulletin 917 for additional information.</p> <p>Automated parts added to allow the MultiSlide door to integrate with the Marvin Connected Home app. See Product Bulletin 906 for additional information.</p> <p>8/26/2024: The Scenic Retractable Screen is now available up to Nominal 12 ft height. See Product Bulletin 944 for more information.</p> |

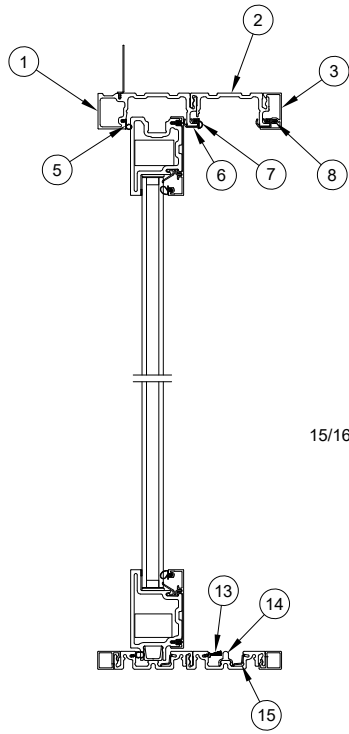

15/16" Glass

Stationary/Pocket Panel Head Jamb and Sill

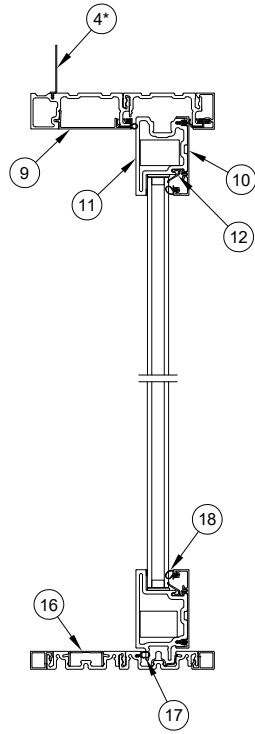

Primary/Inactive Panel Head Jamb and Sill

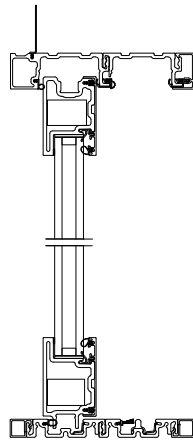

1 1/4" Glass

Stationary/Pocket Panel Head Jamb and Sill

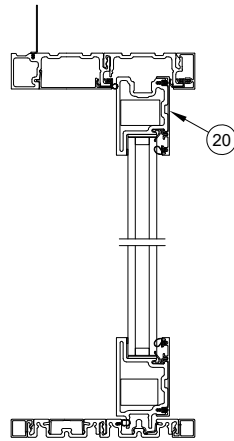

Primary/Inactive Panel Head Jamb and Sill

1. Exterior Frame
2. Frame
3. Frame Liner, A3248
4. Nail Fin, V2920*
5. Frame Weather Strip, V2475
6. Frame Clip, V03263
7. Head Jamb Weather Strip, V2977
8. Connecting Barb, V803
9. Jamb/Head Jamb Exterior Cover, A3476
10. Clad, Locking/Stationary Stile, 15/16" Glass, A3362
11. Stile, Locking/Stationary
12. Glazing Clip, V2874
13. Pile Weather Strip, V2493
14. Roller Track, V2426
15. Sill Slot Cover, A3420
16. Sill Track Cover, A2736
17. Sill Bulb Weather Strip, V2564
18. Interior Glazing Seal, V2949
19. High Performance Sill Liner Nosing, A2863
20. Clad, Locking/Stationary Stile, 1 1/4" Glass, A3349
21. Sill Liner, A3245
22. Performance Sill Liner, A3247
23. High Performance Sill Liner, A3246

*Not included on Pocket Door

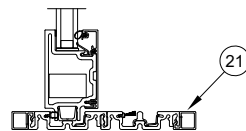

Flush Sill Option

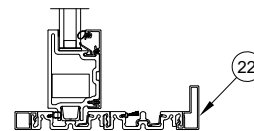

Performance Sill Option

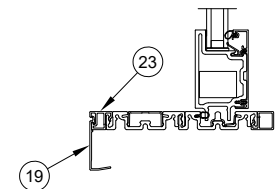

High Performance Sill Option

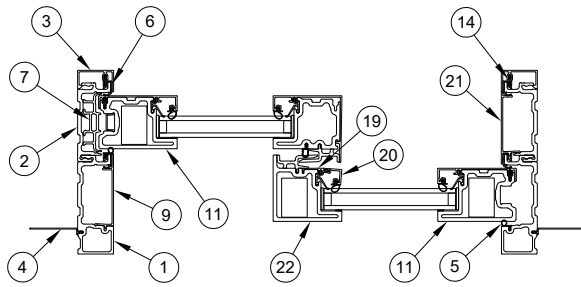

Stacked Uni-directional Jamb Detail

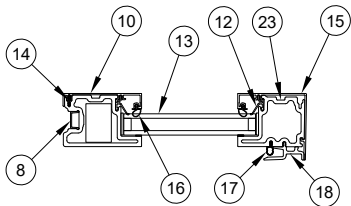

1 5/16" Uni-directional Panel

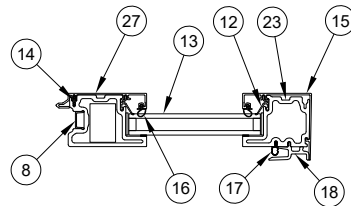

1 5/16" Bi-parting Panel

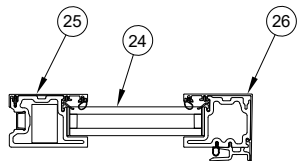

1 1/4" Uni-directional Panel

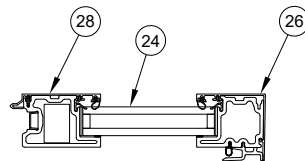

1 1/4" Bi-parting Panel

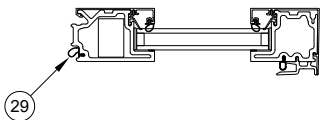

Inactive Panel

1. Exterior Frame
2. Frame
3. Frame Liner, A3248
4. Nail Fin, V2920
5. Frame Weather strip, V2475
6. Frame Clip, V03263
7. Jamb Filler, V2915
8. Cover, Locking Stile, V2885
9. Jamb/Head Jamb Exterior Cover, A3476
10. Clad, Locking/Stationary Stile 15/16" Glass, A3362
11. Stile, Locking/Stationary
12. Glazing Clip, V2874
13. 15/16" Insulating Glass
14. Connecting Barb, V803
15. Clad, Interlocking Stile, 15/16" Glass, A3363
16. Interior Glazing Seal, V2949
17. Bulb Weather Strip, Sill and Panel, V2564
18. Interlock, V2875
19. Exterior, Interlocking Stile Clad Connector, V2966
20. Clad, Exterior Interlocking Stile, A3409
21. Jamb/Head Jamb Interior Cover, A3244
22. Stile, Exterior Interlocking
23. Stile, Interior Interlocking
24. 1 1/4" Insulating Glass
25. Clad, Locking/Stationary Stile, 1 1/4" Glass, A3349
26. Clad, Interior Interlocking Stile, 1 1/4" Glass, A3350
27. Clad, Locking Stile, Bi-Parting 15/16" Glass, A3366
28. Clad, Locking Stile, Bi-Parting 1 1/4" Glass, A3352
29. Bi-parting Meeting Stile Weather Strip, V2968

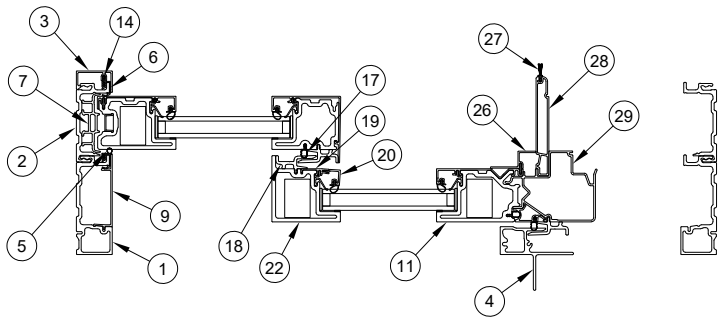

Pocket Uni-directional Jamb Detail

1. Exterior Frame
2. Frame
3. Frame Liner, A3248
4. Pocket Interlock
5. Frame Weather Strip, V2475
6. Frame Clip, V03263
7. Jamb Filler, V2915
8. Cover, Locking Stile, V2885
9. Jamb/Head Jamb Exterior Cover, A3476
10. Clad, Locking/Stationary Stile 15/16" Glass, A3362
11. Stile, Locking/Stationary
12. Glazing Clip, V2874
13. 15/16" Insulating Glass
14. Connecting Barb, V803
15. Clad, Interlocking Stile, 15/16" Glass, A3363
16. Interior Glazing Seal, V2949
17. Bulb Weather Strip, Sill and Panel, V2564
18. Interlock, V2875
19. Exterior, Interlocking Stile Clad Connector, V2966
20. Clad, Exterior Interlocking Stile, A3409
21. 1 1/4" Insulating Glass
22. Stile, Exterior Interlocking
23. Stile, Interior Interlocking
24. Clad, Locking/Stationary Stile, 1 1/4" Glass, A3354
25. Clad, Interior Interlocking Stile 1 1/4" Glass, A3350
26. Pocket Cover Trim, A3291
27. Pile Weather Strip, V2493
28. Pocket Cover, A3293
29. Pocket Interlock Support Block, A3313
30. Clad, Locking Stile, Bi-Parting 15/16" Glass, A3366
31. Clad, Locking Stile, Bi-Parting 1 1/4" Glass, A3352

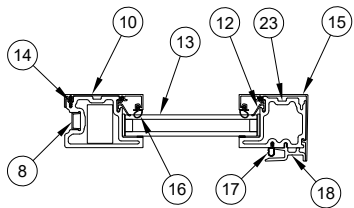

15/16 Uni-directional Panel

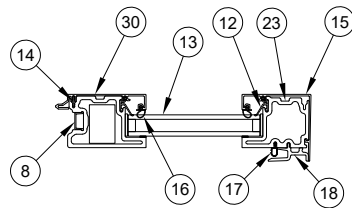

15/16 Bi-parting Panel

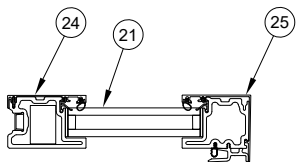

1 1/4 Uni-directional Panel

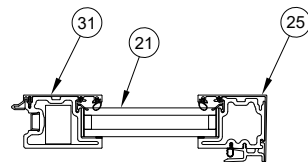

1 1/4 Bi-parting Panel

To order complete Replacement Panels and/or Replacement Sills, refer to Configured Parts in OMS.

Sill Corner Key

Includes:

- 1 - Key, jamb to sill
- 2 - #8 x 1 3/4", TEK 2, Torx, Pan head stainless steel screws
- 2 - #8 x 1/2" full thread, Torx, Pan head stainless steel screws

| Handing | Color | PN |
|---------|-------|----------|
| LH | Black | 11862438 |
| RH | | 11862439 |

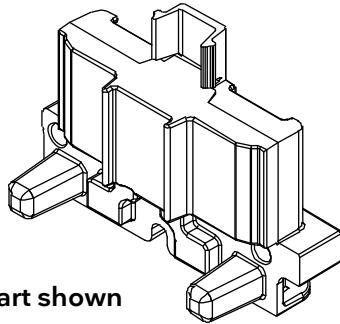

LH part shown

Exterior Frame Hollow Corner Key Kit

Includes:

- 1 - Key, exterior frame hollow
- 4 - #8 x 1/2" full thread, Torx, Pan head stainless steel screw

| Color | PN |
|-------|----------|
| Black | 11862440 |

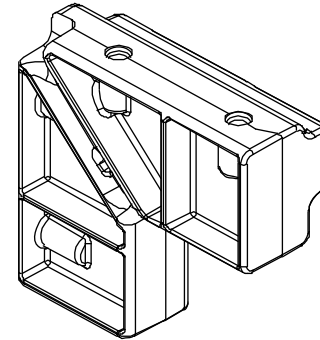

Head Jamb Corner Key Kit

Includes:

- 1 - Key, Jamb to head jamb
- 4 - #8 x 1/2" full thread, Torx, Pan head stainless steel screws

| Color | PN |
|-------|----------|
| Black | 11862441 |

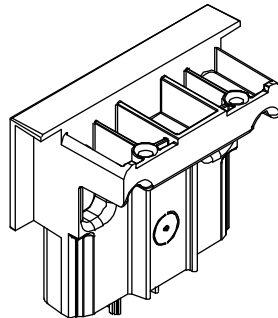

Head Jamb Corner Key, Exterior

Includes:

- 1 - Key, jamb to head jamb, exterior
- 4 - #8 x 1/2" full thread, Torx, Pan head stainless steel screws

| Color | PN |
|-------|----------|
| Black | 11862442 |

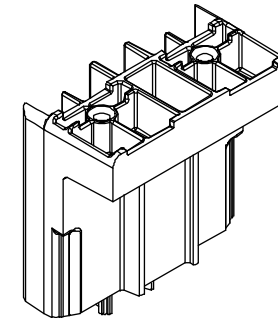

Exterior Frame Hollow Splice Key

Includes:

- 1 - Key, splice, frame, exterior
- 2 - #8 x 1/2" full thread, Torx, Pan head stainless steel screws

| Color | PN |
|-------|----------|
| Black | 11862443 |

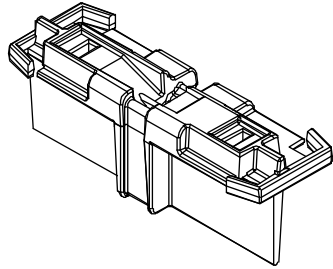

Exterior Flat Shim

Adhesive backed

| Qty | PN |
|-----------|----------|
| Pkg of 20 | 11102179 |

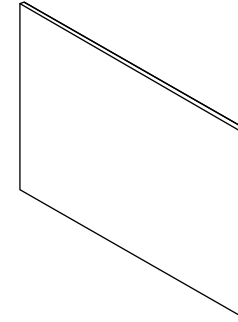

Interior Flat Shim

Adhesive backed

| Qty | PN |
|-----------|----------|
| Pkg of 20 | 11102180 |

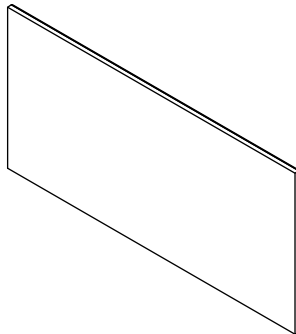

Interior Counter Shim

| Color | PN |
|-------|----------|
| Black | 11102175 |

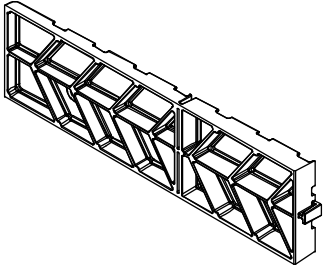

Middle Counter Shim

| Color | PN |
|-------|----------|
| Black | 11102174 |

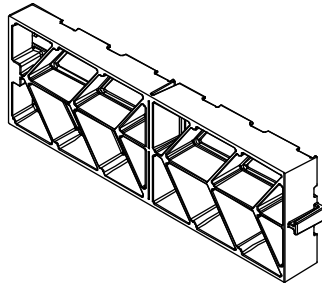

Exterior Counter Shim

| Color | PN |
|-------|----------|
| Black | 11102176 |

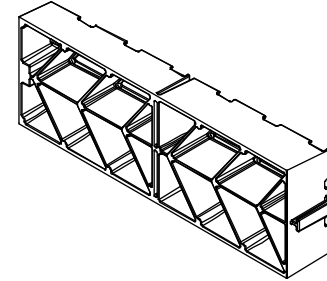

Installation Tools Kit

Includes:

1 - Long arm Allen wrench, M5

Usage dates:

4/26/2021 to present

| PN |
|----------|
| 11862829 |

No illustration available

Fastener Kit, Black Bag*

Includes:

25 - #8-12 x 3" Torx T20, pan head, 2/3 thread screws

Products:

All windows and doors

| Color | PN 25/bag | PN 200/box |
|-------------|-----------|------------|
| Matte Black | 11862478 | 11862477 |

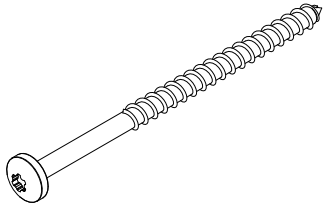

Fastener Kit, Red Bag*

Includes:

16 - #8-18 x 1/2" Type AB, full thread screws

Products:

All windows and doors

| Color | PN 16/bag |
|-----------------|-----------|
| Stainless Steel | 11862475 |

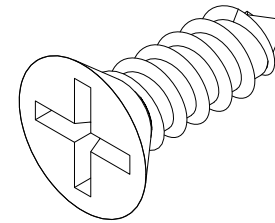

Fastener Kit, Green Bag*

Includes:

16 - #8-18 x 1 3/4" Tek-2, pan head, Torx T20, full thread screws

Products:

All windows and doors

| Color | PN 16/bag |
|-----------------|-----------|
| Stainless Steel | 11862476 |

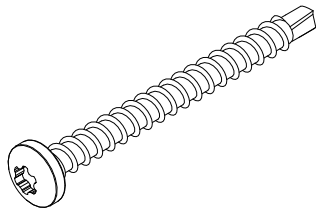

*NOTE: Colors refer to color coded bags.

| Parts in Kit | Uni-Directional Stacked | | | | |
|---|-------------------------|----------|----------------|------------------|--------------------|
| | OX/XO | OXO/XXO | OXXX/ XXXXO | OXXXX/ XXXXXO | OXXXXX/ XXXXXXO |
| | Part Number | | | | |
| | 11862449 | 11862450 | 11862451 | 11862452 | 11862453 |
| | Quantity in Kit | | | | |
| Pocket Bumper/2 per kit | 0 | 0 | 0 | 0 | 0 |
| Pocket Cover Support Bracket Kit | 0 | 0 | 0 | 0 | 0 |
| Bumper, .532" | 0 | 0 | 0 | 0 | 0 |
| Gasket, Pocket Interlock (Includes both LH and RH gasket) | 0 | 0 | 0 | 0 | 0 |
| Screw, #8 x 15 x 2.500" 2/3 thread | 0 | 0 | 0 | 0 | 0 |
| Stationary Bracket Kit | 1 | 1 | 1 | 1 | 1 |
| Shoot Bolt Strike Kit | 0 | 0 | 0 | 0 | 0 |
| Screw, #8 x 15 x 3", 2/3 thread | 1 | 1 | 1 | 1 | 1 |
| Header Part Stop Foam Seal | 1 | 2 | 3 | 4 | 5 |
| Sill Drain Filter | 1 | 2 | 3 | 4 | 5 |
| Bumper, .125" | 2 | 0 | 0 | 0 | 0 |
| Panel Bumper Kit (Panel A to B) | 0 | 1 | 1 | 1 | 1 |
| Panel Bumper Kit (Panel B to B) | 0 | 0 | 1 | 2 | 3 |
| Stile Plug, Inactive Interior Interlock | 1 | 2 | 3 | 4 | 5 |
| Screw, #8 x 1.750, Tek-2 | 1 | 1 | 2 | 2 | 2 |
| Screw, #8 x .500 Torx | 1 | 2 | 2 | 2 | 2 |
| Dust Block, 1/2" x 1 1/2" x 1/2" Pile | 4 | 4 | 4 | 4 | 4 |

| Parts in Kit | Uni-Directional Pocket | | | | | |
|---|------------------------|----------|-----------|-------------|---------------|-----------------|
| | PX/XP | PXX/XXP | PXXX/XXXP | PXXXX/XXXXP | PXXXXX/XXXXXX | PXXXXXX/XXXXXXP |
| | Part Number | | | | | |
| | 11862454 | 11862455 | 11862456 | 11862457 | 11862458 | 11862459 |
| | Quantity in Kit | | | | | |
| Pocket Bumper/2 per kit | 1 | 1 | 1 | 1 | 1 | 1 |
| Pocket Cover Support Bracket Kit | 0 | 0 | 0 | 1 | 1 | 1 |
| Bumper, .532" | 0 | 0 | 2 | 2 | 2 | 2 |
| Gasket, Pocket Interlock (Includes both LH and RH gasket) | 1 | 1 | 1 | 1 | 1 | 1 |
| Screw, #8 x 15 x 2.500" 2/3 thread | 1 | 1 | 1 | 1 | 1 | 1 |
| Stationary Bracket Kit | 0 | 0 | 0 | 0 | 0 | 0 |
| Shoot Bolt Strike Kit | 0 | 0 | 0 | 0 | 0 | 0 |
| Screw, #8 x 15 x 3", 2/3 thread | 1 | 1 | 1 | 1 | 1 | 1 |
| Header Part Stop Foam Seal | 0 | 1 | 2 | 3 | 4 | 5 |
| Sill Drain Filter | 0 | 1 | 2 | 3 | 4 | 5 |
| Bumper, .125" | 0 | 2 | 0 | 0 | 0 | 0 |
| Panel Bumper Kit (Panel A to B) | 0 | 0 | 1 | 1 | 1 | 1 |
| Panel Bumper Kit (Panel B to B) | 0 | 0 | 0 | 1 | 2 | 3 |
| Stile Plug, Inactive Interior Interlock | 0 | 1 | 2 | 3 | 4 | 5 |
| Screw, #8 x 1.750, Tek-2 | 3 | 3 | 3 | 3 | 4 | 4 |
| Screw, #8 x .500 Torx | 1 | 1 | 2 | 2 | 2 | 2 |
| Dust Block, 1/2" x 1 1/2" x 1/2" Pile | 4 | 4 | 4 | 4 | 4 | 4 |

| Parts in Kit | Bi-Parting Stacked | | | |
|---|--------------------|----------|-----------|-------------|
| | OX/XO | OXX/XXO | OXXX/XXXO | OXXXX/XXXXO |
| | Part Number | | | |
| | 11862460 | 11862461 | 11862462 | 11862463 |
| | Quantity in Kit | | | |
| Pocket Bumper/2 per kit | 0 | 0 | 0 | 0 |
| Pocket Cover Support Bracket Kit | 0 | 0 | 0 | 0 |
| Bumper, .532" | 0 | 0 | 0 | 0 |
| Gasket, Pocket Interlock (Includes both LH and RH gasket) | 0 | 0 | 0 | 0 |
| Screw, #8 x 15 x 2.500" 2/3 thread | 0 | 0 | 0 | 0 |
| Stationary Bracket Kit | 2 | 2 | 2 | 2 |
| Shoot Bolt Strike Kit | 1 | 1 | 1 | 1 |
| Screw, #8 x 15 x 3", 2/3 thread | 0 | 0 | 0 | 0 |
| Header Part Stop Foam Seal | 2 | 4 | 6 | 8 |
| Sill Drain Filter | 2 | 4 | 6 | 8 |
| Bumper, .125" | 4 | 0 | 0 | 0 |
| Panel Bumper Kit (Panel A to B) | 0 | 2 | 2 | 2 |
| Panel Bumper Kit (Panel B to B) | 0 | 0 | 2 | 4 |
| Stile Plug, Inactive Interior Interlock | 2 | 4 | 6 | 8 |
| Screw, #8 x 1.750, Tek-2 | 1 | 1 | 2 | 2 |
| Screw, #8 x .500 Torx | 1 | 2 | 2 | 2 |
| Dust Block, 1/2" x 1 1/2" x 1/2" Pile | 0 | 0 | 0 | 0 |

| Parts in Kit | Uni-Directional Pocket | | | | |
|---|------------------------|----------|-----------|-------------|---------------|
| | PX/XP | PXX/XXP | PXXX/XXXP | PXXXX/XXXXP | PXXXXX/XXXXXX |
| | Part Number | | | | |
| | 11862464 | 11862465 | 11862466 | 11862467 | 11862468 |
| | Quantity in Kit | | | | |
| Pocket Bumper/2 per kit | 1 | 1 | 1 | 1 | 1 |
| Pocket Cover Support Bracket Kit | 2 | 2 | 2 | 2 | 2 |
| Bumper, .532" | 0 | 0 | 0 | 2 | 2 |
| Gasket, Pocket Interlock (Includes both LH and RH gasket) | 0 | 0 | 4 | 4 | 4 |
| Screw, #8 x 15 x 2.500" 2/3 thread | 1 | 1 | 1 | 1 | 1 |
| Stationary Bracket Kit | 2 | 2 | 2 | 2 | 2 |
| Shoot Bolt Strike Kit | 0 | 0 | 0 | 0 | 0 |
| Screw, #8 x 15 x 3", 2/3 thread | 1 | 1 | 1 | 1 | 1 |
| Header Part Stop Foam Seal | 0 | 0 | 0 | 0 | 0 |
| Sill Drain Filter | 0 | 2 | 4 | 6 | 8 |
| Bumper, .125" | 0 | 2 | 4 | 6 | 8 |
| Panel Bumper Kit (Panel A to B) | 0 | 4 | 0 | 0 | 0 |
| Panel Bumper Kit (Panel B to B) | 0 | 0 | 2 | 2 | 2 |
| Stile Plug, Inactive Interior Interlock | 0 | 2 | 4 | 6 | 8 |
| Screw, #8 x 1.750, Tek-2 | 5 | 5 | 5 | 6 | 6 |
| Screw, #8 x .500 Torx | 1 | 1 | 2 | 2 | 2 |
| Dust Block, 1/2" x 1 1/2" x 1/2" Pile | 0 | 0 | 0 | 0 | 0 |

Trim Set, Active Keyed

| Handing | Color | PN |
|---------|--------------|----------|
| LH | Matte Black | 10501558 |
| | Matte Bronze | 10501559 |
| | Satin Nickel | 10501560 |
| | Silver | 10501561 |
| | Stone White | 10501571 |
| RH | Matte Black | 10501562 |
| | Matte Bronze | 10501563 |
| | Satin Nickel | 10501564 |
| | Silver | 10501565 |
| | Stone White | 10501572 |

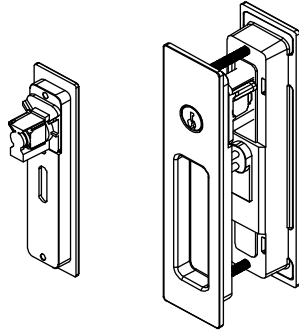

Trim Set, Active, Non-Keyed

| Color | PN |
|--------------|----------|
| Matte Black | 10501583 |
| Matte Bronze | 10501584 |
| Satin Nickel | 10501585 |
| Silver | 10501586 |
| Stone White | 10501574 |

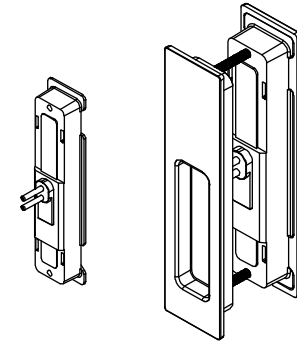

Trim Set, Inactive

| Color | PN |
|--------------|----------|
| Matte Black | 10501566 |
| Matte Bronze | 10501567 |
| Satin Nickel | 10501568 |
| Silver | 10501569 |
| Stone White | 10501573 |

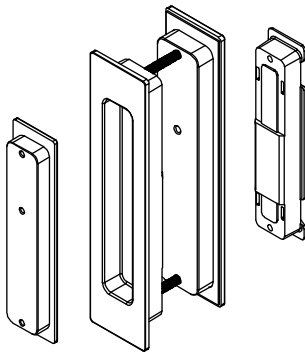

Edge Pull Kit - Pocketing Units

Includes:

- 1 - Edge pull
- 2 - #7-19 x 7/8" Type AB Phillips head screws

| Color | PN |
|--------------|----------|
| Satin Chrome | 11862432 |

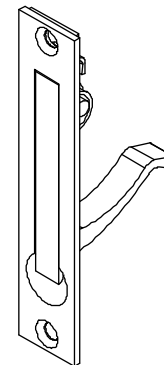

Trim Set, Keyed Cylinder

Includes:

- 2 - Keys

NOTE: For keyed alike cylinders, please contact your Marvin representative. Please supply the original order number, if available.

| PN |
|----------|
| 10830174 |

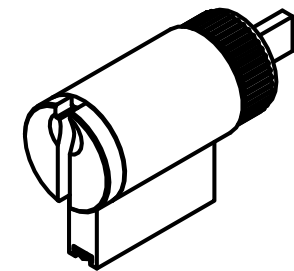

Roller, Hoppe (Series 360) Kit

Includes:

- 1 - Roller
- 2 - #8 -19 x 1/2" Torx Phillips head screws

| Color | PN |
|-----------------|----------|
| Stainless Steel | 11862431 |

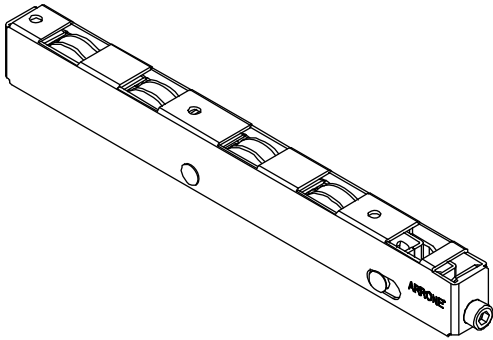

Lock Box, Hoppe Kit

Includes:

- 1 - Lock box
- 7 - #7-10 x 7/8" Type AB Phillips head screws

| PN |
|----------|
| 11862430 |

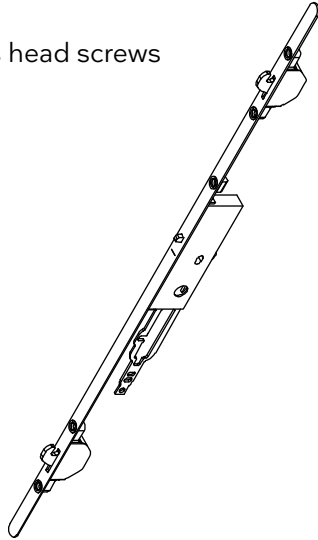

Flush Bolt Rod

Includes:

- 1 - Locking rod with end bolt

| Length | PN |
|-----------|----------|
| 11 1/32" | 05700180 |
| 27 1/32" | 05700185 |
| 34 9/32" | 05700170 |
| 41 15/16" | 05700177 |
| 51 7/16" | 05700179 |
| 63 7/16" | 05700191 |

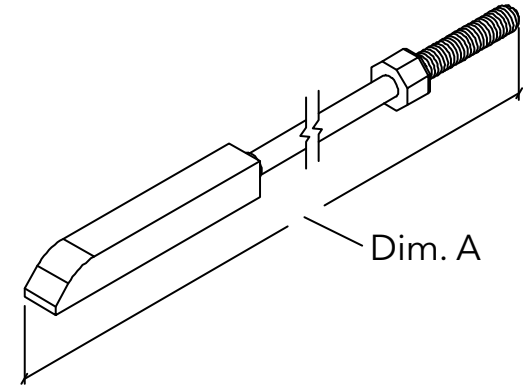

Jamb Strike, Hoppe Kit

Includes:

- 1 - Strike
- 3 - #8-18 x 1/2" type AB Phillips head screws
- 4 - #8-15 x 3" 2/3 thread Phillips head screws

| Color | PN |
|-----------------|----------|
| Stainless Steel | 11862435 |

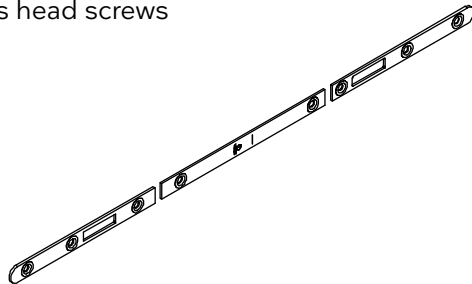

Panel Strike, Hoppe Kit

Includes:

- 1 - Strike
- 7 - #7-19 x 7/8" type AB Phillips head screws

| Color | PN |
|-----------------|----------|
| Stainless Steel | 11862434 |

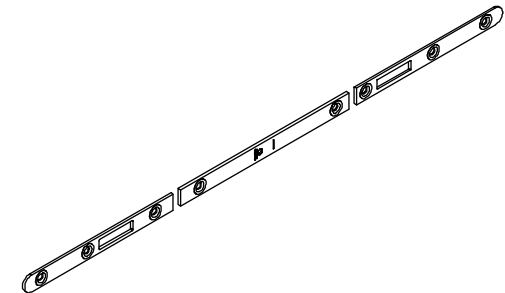

Shoot Bolt Strike Kit

Includes:

- 1 - Strike, shoot bolt
- 2 - #10-12 x 3", 2/3 thread, Torx T20 head screws

| Color | PN |
|-------|----------|
| Black | 11862425 |

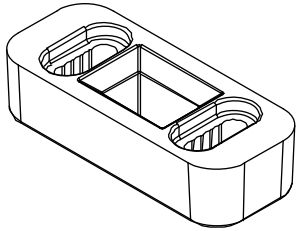

Shoot Bolt Guide

| PN |
|----------|
| 10501544 |

| Suggested Fasteners | PN |
|---|----------|
| 1 - #8 x 1" TEK-3, Phillips, pan head screw | 11800180 |

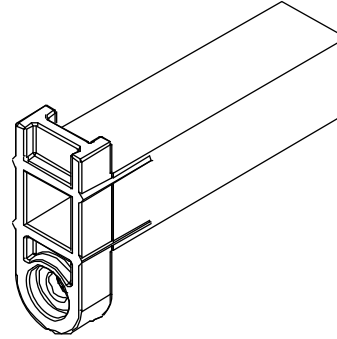

Flush Bolt Assembly

| Color | PN |
|-------|----------|
| Black | 11101780 |

| Suggested Fasteners | PN |
|--|----------|
| 2 - #7-19 x 7/8" Type AB, full thread, P2, Phillips head, stainless steel screws | 11800777 |

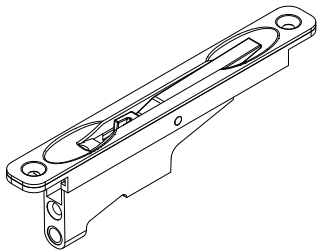

Flush Bolt Trim Cover

Includes:

- 1 - Flush bolt trim cover
- 2 - #7-19 x 7/8" Type AB, full thread, P2, Phillips head, stainless steel screws

| PN |
|----------|
| 11862433 |

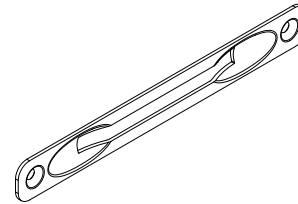

Magnet Assembly Housing

| Color | PN |
|-------|----------|
| Black | 10815371 |

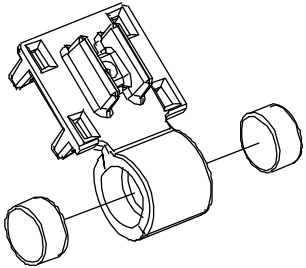

Turnbuckle Assembly

Includes:

- 1 - Turnbuckle
- 2 - 1/4-20 x 1" full thread, flat head P3 screw

| Handing | PN |
|---------|----------|
| LH | 10507605 |
| RH | 10507606 |

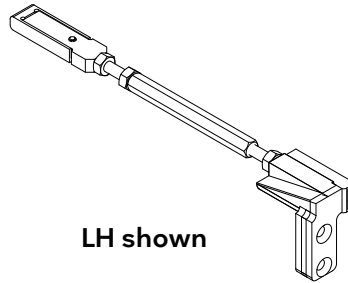

LH shown

Turnbuckle Barrel

| Length | PN |
|--------|----------|
| 4" | 15007628 |
| 10" | 10507629 |

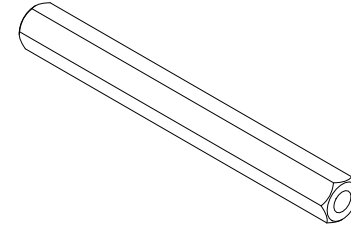

Transmitter Housing

| Color | PN |
|-------|----------|
| Black | 10501896 |

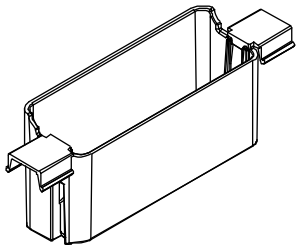

Transmitter Cover

| Color | PN |
|-------|----------|
| Black | 10501898 |

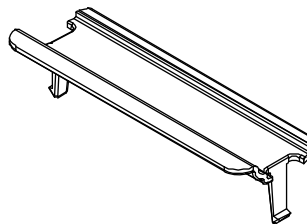

Bracket, Sensor

| Color | PN |
|-------|----------|
| Black | 10501899 |

| Suggested Fasteners | PN |
|---|----------|
| 1 - #8-18 x 7/16" TEK-2 Phillips, full thread, pan head screw | 11800177 |

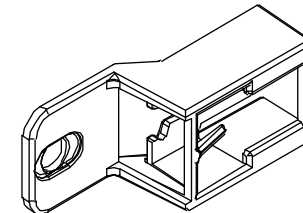

Reed Capsule

| Color | PN |
|-------|----------|
| Black | 10501846 |

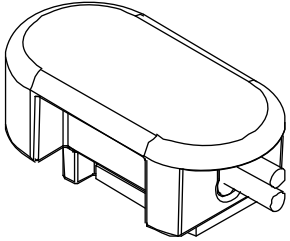

Pulley Corner Key

Includes:

- 1 - Bracket
- 4 - #8-15 x 3" type A/TF, 2/3 thread screw

| PN |
|----------|
| 10507609 |

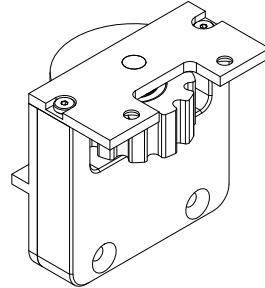

Bi-Parting Belt Clamp

Includes:

- 1 - Bracket
- 2 - 1/4-20 x 1" full thread, flat head P3 screw

| Handing | PN |
|---------|----------|
| LH | 10507607 |
| RH | 10507608 |

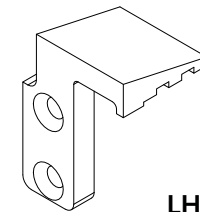

LH shown

Motor

| Model | PN |
|---------|----------|
| Everest | 10507610 |
| Peak | 10507600 |



Control Box

(Configurable to Motor)

| PN |
|----------|
| 10507601 |



C13 18" Power Cord

| PN |
|----------|
| 10507621 |

No illustration available

Closing Ramp Assembly

Includes:

- 1 - Bracket
- 2 - #8-18 x 3" type AB, Phillips head, full thread screw

| PN |
|----------|
| 10507611 |

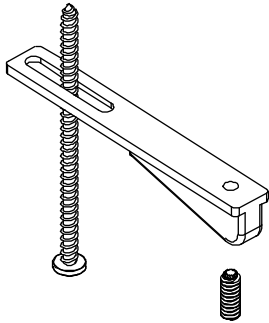

Exterior Wall Switch

| Color | PN |
|-------|----------|
| Black | 10507612 |
| White | 10507613 |



Interior Wall Switch

| PN |
|----------|
| 10507614 |



T1 Sensor

| PN |
|----------|
| 10507615 |



H1 Sensor

| PN |
|----------|
| 10507616 |



Android/IOS Bluetooth Module

| PN |
|----------|
| 10507618 |



Voice Command Module

| PN |
|----------|
| 10507617 |



Belt

NOTE: Order by foot - belt calculation is frame width x 2 + 4'

| Color | PN |
|-------|----------|
| Black | 10507620 |

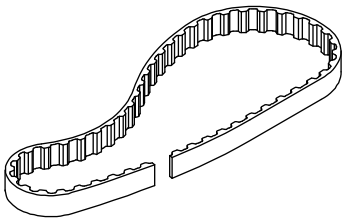

Belt Clip

| Color | PN |
|-------|----------|
| Black | 10507619 |

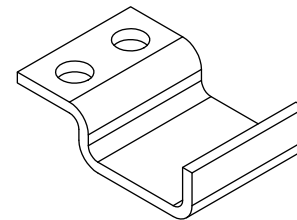

Power Transfer Device Kit, Panel

Includes:

- 1 - Power Transfer Device
- 1 - Magnet
- 2 - #8 x 1" TEK-3, Phillips pan head stainless steel screws

| PN |
|----------|
| 11862384 |

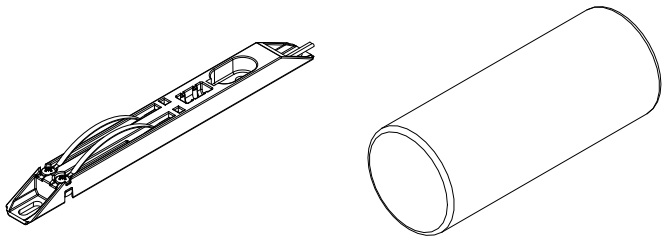

Power Transfer Device Kit, Frame

Includes:

- 1 - Power Transfer Device
- 1 - Reed Capsule
- 2 - #10-12 x 3" Torx, T20, pan head, 2/3 thread screws

| PN |
|----------|
| 11862383 |

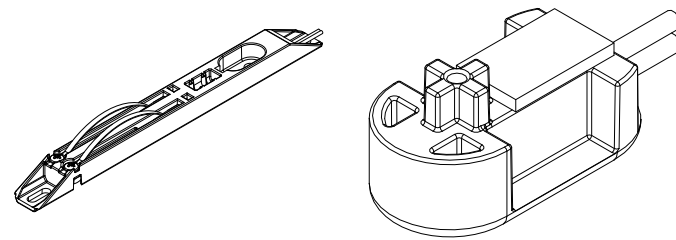

Power Transfer Device Wire Kit, Bi-Parting

Includes:

- 4 - Wire Connector
- 2 - Wire Lock/Close, 25'

| PN |
|----------|
| 11862385 |

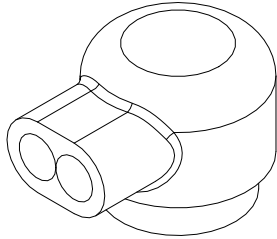

Marvin Control Module Kit

Includes:

- 1 - Marvin Control Module
- 1 - 18" Wire, aux to brake
- 1 - 2' CAT5E wire
- 2 - #8-32 x 5/16" Phillips, pan head stainless steel screws

| PN |
|----------|
| 11852598 |

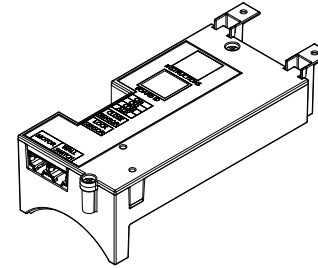

Wire Harness, CAT5E, 2'

| PN |
|----------|
| 10810035 |

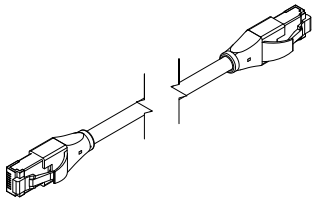

NOTE: The following cables are required, and should be locally sourced for purchase.

Communication Cables

Shielded Cat5e cable with shielded RJ45 connections

Motor Power Cable

Shielded Stranded 14-2 Cable

Stationary Bracket Kit

Includes:

- 1 - Upper stationary bracket
- 1 - #10-12 x 3", Torx T20, 2/3 thread screw
- 1 - #8 x 1", TEK 3, full thread, P2, Phillips pan head screw
- 2 - Lower stationary bracket
- 1 - #8-18 x 7/16" TEK-2 Phillips, full thread, pan head screw
- 1 - #8-18 x 1 1/2", 2/3 thread, A/TF flat head screw

| Color | PN |
|----------|----------|
| Aluminum | 11862424 |

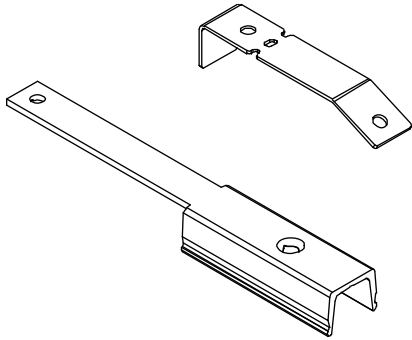

Upper Stationary Bracket (Top)
Lower Stationary Bracket (Bottom)

Pocket Cover Support Bracket Kit

Includes:

- 2 - Pocket support cover brackets
- 4 - #8-18 x 7/16" TEK-2 Phillips, full thread, pan head screw

| PN |
|----------|
| 11862426 |

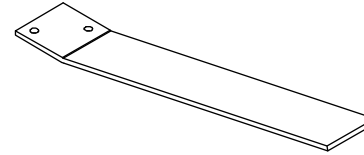

Bumper, .532"

| PN |
|----------|
| 10501592 |

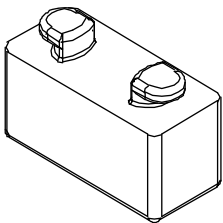

Bumper, .125"

| PN |
|----------|
| 10501591 |

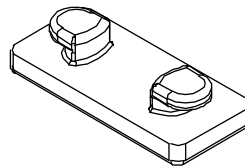

Pocket Bumper Kit

Includes:

- 2 - Bumper, pocket jamb
- 2 - #10-12 x 3" Torx T20, 2/3 thread screws

| Color | PN |
|-------|----------|
| Black | 11862429 |

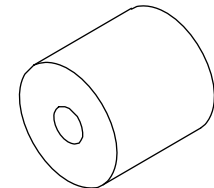

Panel Bumper Kit (panel A to panel B)

Includes:

- 2 - Bumper, secondary to primary
- 2 - Bumper, .375"
- 4 - #10-16 x 1 1/2" P2 flat head, full thread, TEK 2 screws

| Color | PN |
|-------|----------|
| Black | 11862427 |

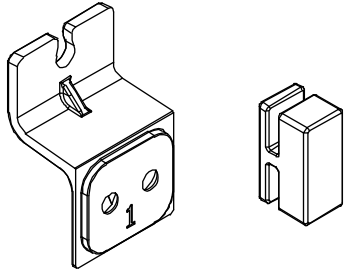

Panel Bumper Kit (panel B to panel B)

Includes:

- 2 - Bumper, secondary to secondary
- 2 - Bumper, .375"
- 4 - #10-16 x 1 1/2" P2 flat head, full thread, TEK 2 screws

| Color | PN |
|-------|----------|
| Black | 11862428 |

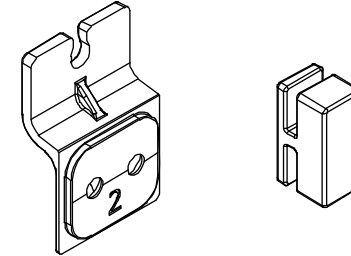

Sill Drain Filter

| Color | PN |
|-------|----------|
| Black | 10500240 |

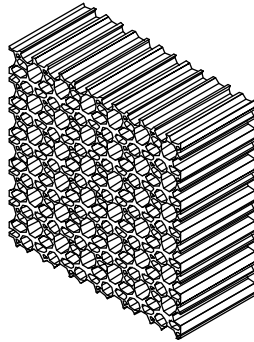

Header Part Stop Foam Seal

| Color | PN |
|-------|----------|
| Black | 10500436 |

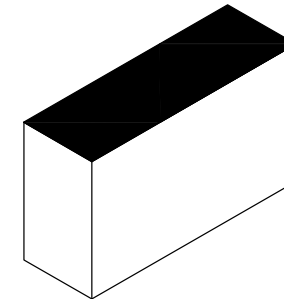

Gasket, Pocket Interlock

| Color | PN |
|-------|----------|
| Black | 10501546 |

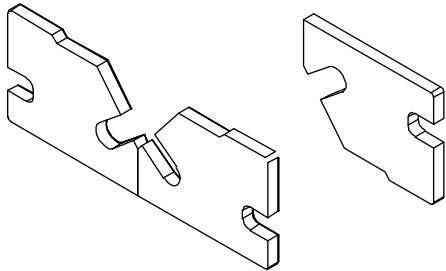

End Cap, HP Sill Liner

| Handing | Color | PN |
|---------|-------|----------|
| LH | Black | 10501543 |
| RH | | 10501542 |

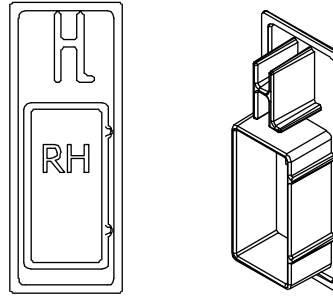

RH part shown

Sill Liner Splice Key, Flush Performance, Kit

Includes:

- 1 - Splice key
- 2 - #8-18 x 1/2", Type AB, full thread, Phillips head, stainless steel screws

| Color | PN |
|-------|----------|
| Black | 11862436 |

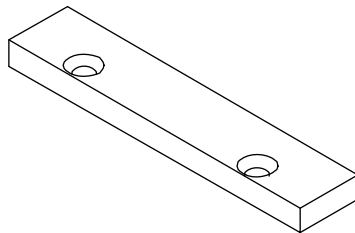

Sill Liner Splice Key, High Performance, Kit

Includes:

- 1 - Splice key, High Performance
- 2 - #8-18 x 1/2", Type AB, full thread, Phillips head, stainless steel screws

| Color | PN |
|-------|----------|
| Black | 11862437 |

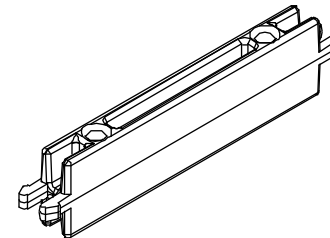

Stile Hole Cover, Exterior, Kit

Includes:

- 2 - Stile hole covers
- 2 - Cover retainer bracket
- 2 - #8-18 x 1 3/4" full thread pan head screws

| Color | PN |
|-------------|----------|
| Bronze | 11862444 |
| Ebony | 11862445 |
| Gunmetal | 11862446 |
| Silver | 11862447 |
| Stone White | 11862448 |

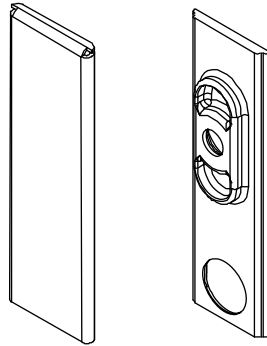

Cover Retainer Bracket

| Color | PN |
|-------|----------|
| Black | 10501594 |

| Suggested Fasteners | PN |
|---|----------|
| 1 - #8-18 x 1 3/4" full thread pan head screw | 11808176 |

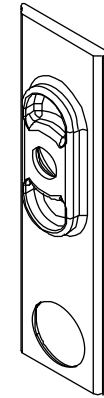

Stile Plug, Inactive Interior Interlock

| Color | PN |
|-------|----------|
| Black | 10500412 |

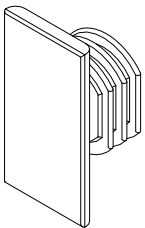

Weep Hole Cover

| Color | PN |
|-------|----------|
| Black | 10501910 |

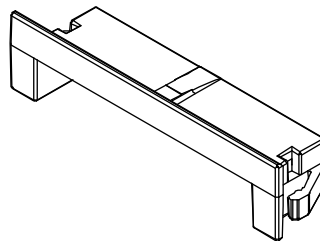

Dust Block Holder, Interior

| Color | PN |
|-------|----------|
| Black | 10500725 |

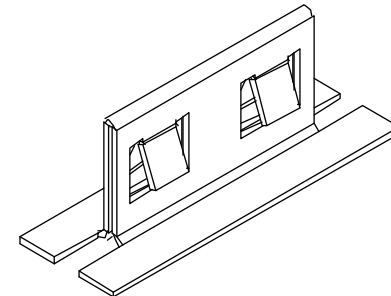

Dust Block, 1/2" x 2 1/4" x 1/2" Pile

Bottom of Exterior Interlock

| Color | PN |
|-------|----------|
| Black | 10500483 |

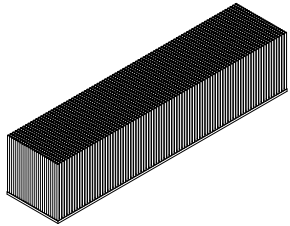

Dust Block, 1/2" x 1 1/2" x 1/2" Pile

Top and bottom of Interior Interlock

Top of Exterior Interlock

Inactive Panel Shoe

Locking/Stationary Jamb

Head Jamb

Pocket Sill

| Color | PN |
|-------|----------|
| Black | 10500443 |

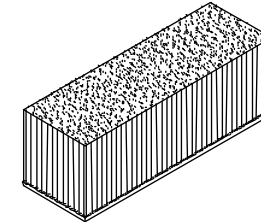

Dust Block, 1/2" x 1 1/8" x 1/2" Pile

Primary Bi Parting Panel Shoe

| Color | PN |
|-------|----------|
| Black | 10500448 |

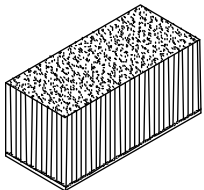

Dust Block, 1/2" x 13/16" x 1/4" Pile

Primary Bi Parting Panel Shoe

| Color | PN |
|-------|----------|
| Black | 10500449 |

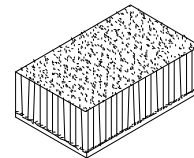

Dust Block
1/2" x 1 1/2" x 3/4" Pile

Bi Parting Sill

| Color | PN |
|-------|----------|
| Black | 10500482 |

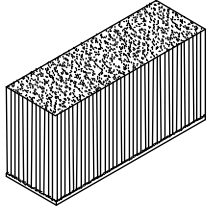

Dust Block
3/4" x 1/2" x 1/2" Pile

| Color | PN |
|-------|----------|
| Black | 10500499 |

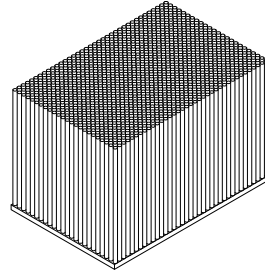

Dust Block
1/4" x 2 1/4" x 1/2" Pile

| Color | PN |
|-------|----------|
| Black | 10500468 |

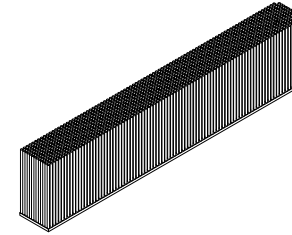

#8-18 x 1/2" Phillips, Pan Head, Tek 2 Screw

| PN |
|----------|
| 11800277 |

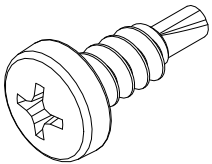

Panel Leveling Block Kit, Stationary Panel

A2810

Modern MultiSlide Door Stacked

Includes:

- 2 - Leveling blocks
- 2 - #8-15 x 1 1/2" 2/3 thread, A.TF, P2, flat head screws

| Color | PN |
|--------|----------|
| Bronze | 11862387 |

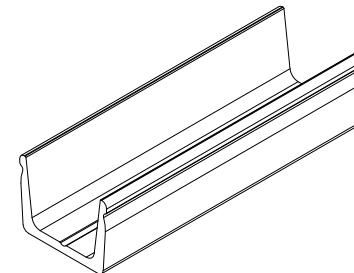

Head Jamb Bracket Kit, Stationary Panel

Modern MultiSlide Door Stacked

Includes:

- 1 - Head jamb bracket
- 4 - #10-12 x 3" 2/3 thread, Torx T20 head screws

| Color | PN |
|-------|----------|
| Black | 11852559 |

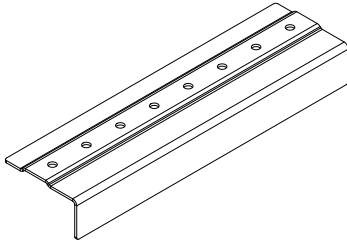

Sill Bracket Kit, Stationary Panel

Modern MultiSlide Door Stacked

Includes:

- 1 - Sill bracket
- 1 - #8-18 x 1/2" Phillips, pan head, Tek 2 screw

| Color | PN |
|-------|----------|
| Black | 11852558 |

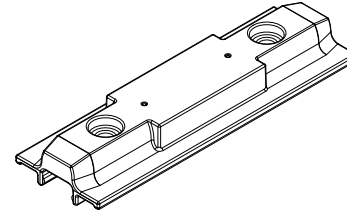

Bumper Bracket Kit, Stationary Sill

Modern MultiSlide Door Stacked

Includes:

- 2 - Bumper brackets
- 2 - Bumpers
- 4 - #10-16 x 1 1/2" P2, flat head, full thread Tek 2 screws

| Color | PN |
|-------|----------|
| Black | 11852556 |

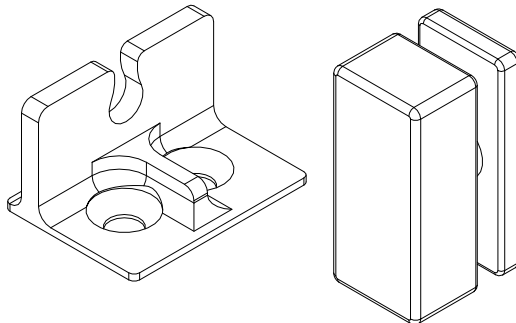

Upper Bracket Kit, Stationary Panel

Modern MultiSlide Door Stacked

Includes:

- 1 - Upper bracket
- 1 - #10-12 x 3" Torx T20, Phillips, 2/3 thread screws
- 1 - #8 x 1" Tek-3 flat head, P2, Phillips, stainless steel screw

| Color | PN |
|--------|----------|
| Bronze | 11852557 |

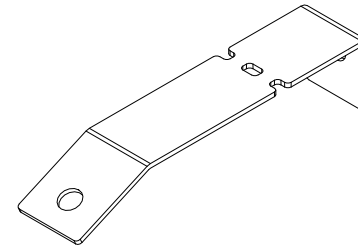

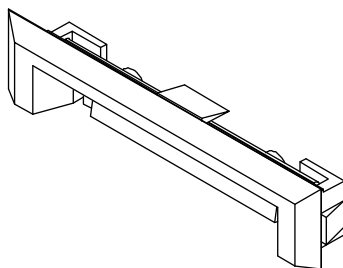

Weep Hole Cover

No longer available, use current.

Jamb Cover, Interior

A3244

| Length | Color | PN |
|-------------|---------------|----------|
| 200" (5080) | Gunmetal | 18818170 |
| | Stone White | 18818165 |
| | Bronze | 18818160 |
| | Clear Anodize | 18818155 |
| | Ebony | 18818150 |



Frame Liner (Head Jamb and Jamb)

A3248

| Length | Color | PN |
|-------------|---------------|----------|
| 200" (5080) | Gunmetal | 18818120 |
| | Stone White | 18818115 |
| | Bronze | 18818110 |
| | Clear Anodize | 18818105 |
| | Ebony | 18818100 |

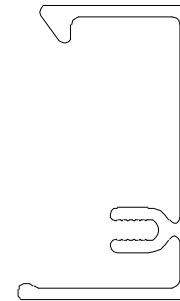

Clad, Locking/Stationary Stile 15/16" Glass

A3362

| Length | Color | PN |
|-------------|---------------|----------|
| 200" (5080) | Gunmetal | 18818220 |
| | Stone White | 18818215 |
| | Bronze | 18818210 |
| | Clear Anodize | 18818205 |
| | Ebony | 18818200 |

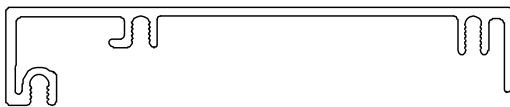

Clad, Locking/Stationary Stile 1 1/4" Glass

A3349

| Length | Color | PN |
|-------------|---------------|----------|
| 200" (5080) | Gunmetal | 18819420 |
| | Stone White | 18819415 |
| | Bronze | 18819410 |
| | Clear Anodize | 18819405 |
| | Ebony | 18819400 |



Trim, Pocket, 1 Deep

A3312

| Length | Color | PN |
|-------------|---------------|----------|
| 200" (5080) | Gunmetal | 18818870 |
| | Stone White | 18818865 |
| | Bronze | 18818860 |
| | Clear Anodize | 18818855 |
| | Ebony | 18818850 |



Pocket Interlock Support Block

A3313

| Length | Color | PN |
|-------------|-------|----------|
| 200" (5080) | Black | 18818900 |

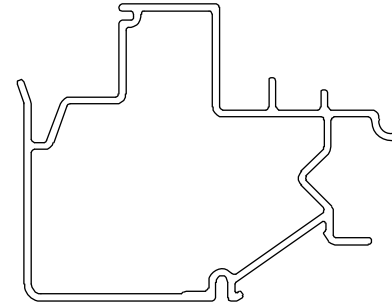

Sill Slot Cover

A3420

| Length | Color | PN |
|------------|-------|----------|
| 98" (2489) | Black | 18819900 |

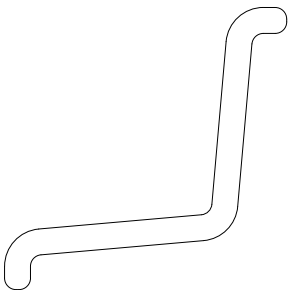

Sill Track Cover

A2736

| Length | Color | PN |
|-------------|--------|----------|
| 200" (5080) | Ebony | 18818050 |
| | Bronze | 18818060 |



Sill Liner

A3245

| Length | Color | PN |
|-------------|--------|----------|
| 200" (5080) | Bronze | 18818010 |
| | Ebony | 18818000 |

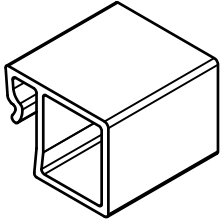

Performance Sill Liner

A3247

| Length | Color | PN |
|-------------|--------|----------|
| 200" (5080) | Bronze | 18818460 |
| | Ebony | 18818450 |

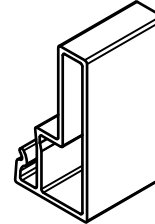

High Performance Sill Liner

A3246

| Length | Color | PN |
|-------------|--------|----------|
| 200" (5080) | Bronze | 18818805 |
| | Ebony | 18818800 |

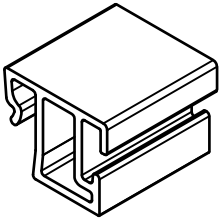

When ordering replacement aluminum parts, specify:

1. Order number/line number (if available);
2. Type of unit;
3. Description;
4. Color;
5. Length.



A3476
Jamb/Head Jamb Cover, Exterior



A2736
Sill Track Cover



A2863
Sill Liner Nosing, HP

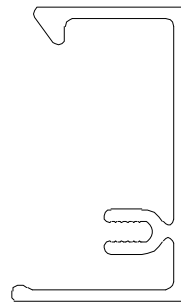

A3248
Frame Liner (Head Jamb and Jamb)

When ordering replacement aluminum parts, specify:

1. Order number/line number (if available)
2. Type of unit
3. Description
4. Color
5. Length



Jamb Cover, Interior , A3244

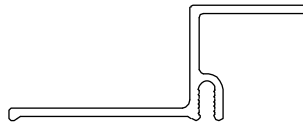

Trim, Pocket Cover A3291

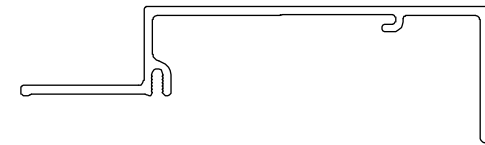

Trim, Pocket, 1 Deep , A3312

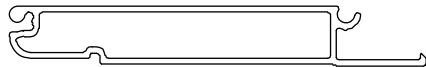

Pocket Cover, Modular, A3292

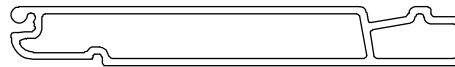

Pocket Cover, A3293

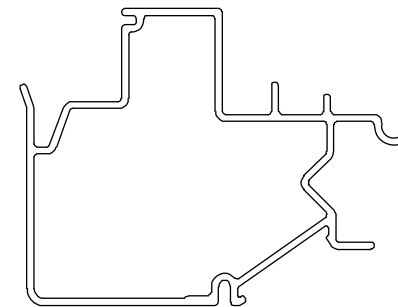

Pocket, Interlock Support Block, A3313

When ordering replacement aluminum parts for, specify:

1. Order number/line number (if available)
2. Type of unit
3. Description
4. Color
5. Length



Clad, Locking/Stationary Stile, A3362
15/16" Glass



Clad, Locking Stile Bi-Parting, A3366
15/16" Glass



Clad, Inactive Stile, A3367
15/16" Glass

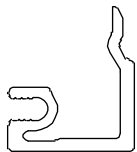

Clad, Exterior Interlock Stile, A3410
15/16" Glass



Clad, Pocket Stile, A3368
15/16" Glass

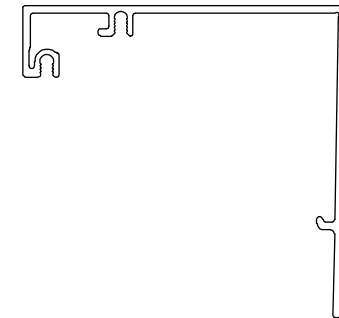

Clad, Interior Interlock Stile, A3363
15/16" Glass

When ordering replacement aluminum parts, specify:

1. Order number/line number (if available)
2. Type of unit
3. Description
4. Color
5. Length

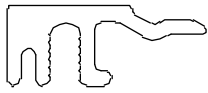

Clad, Exterior Interlock Stile, A3409
1 1/4" Glass

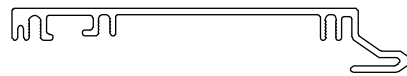

Clad, Locking Stile Bi-Parting, A3352
1 1/4" Glass



Clad, Locking/Stationary Stile, A3349
1 1/4" Glass



Clad, Inactive Stile, A3354
1 1/4" Glass

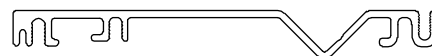

Clad, Pocket Stile, A3355
1 1/4" Glass

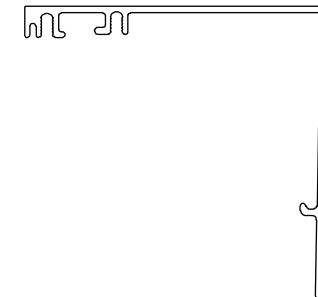

Clad, Interior Interlock Stile, A3350
1 1/4" Glass

Jamb Filler

V2915

| Length | PN |
|-------------|----------|
| 200" (5080) | 16219225 |

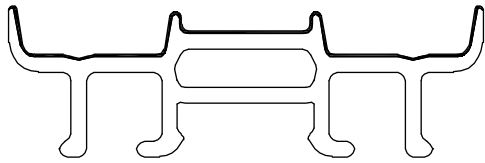

Interlock

V2875

| Length | Color | PN |
|-------------|-------|----------|
| 203" (5156) | Black | 16219215 |

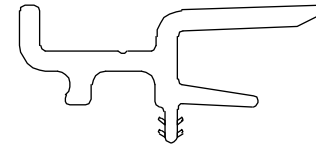

| Suggested Fasteners | PN |
|---|----------|
| #8-1" full thread, phillips pan head screw, black | 11800180 |

Frame Clip

V03263

| Length | Color | PN |
|-------------|-------|----------|
| 203" (5156) | Black | 16219212 |

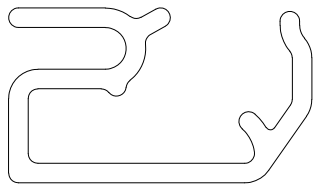

Clad Connector, Exterior Interlock Stile

V2966

| Length | Color | PN |
|-------------|-------|----------|
| 200" (5080) | Black | 16219260 |

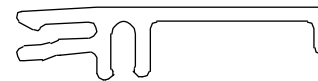

Glazing Clip, 15/16" Glass

V2874

| Length | Color | PN |
|-------------|-------|----------|
| 200" (5080) | Black | 16219205 |

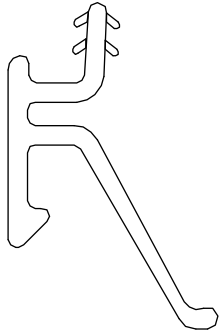

Glazing Clip, 1 1/4" Glass

V2886

| Length | Color | PN |
|-------------|-------|----------|
| 200" (5080) | Black | 16219230 |

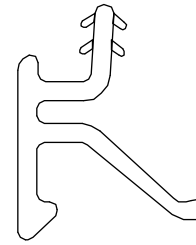

Interior Glazing Seal

V2949

| Length | Color | PN |
|-------------|-------|----------|
| 200" (5080) | Black | 16219235 |



Roller Track

V2426

| Length | Color | PN |
|-------------|-------|----------|
| 150" (3810) | Black | 15984899 |

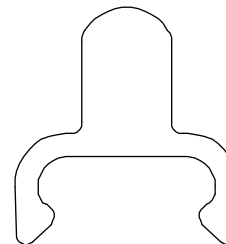

When ordering replacement vinyl parts, specify:

1. Order number/line number (if available)
2. Type of unit
3. Description
4. Length

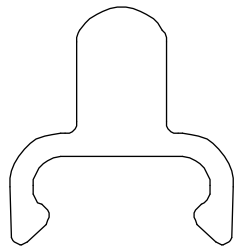

Roller Track, V2426

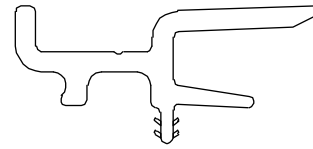

Interlock, V2875

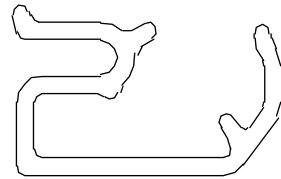

Frame Clip, V2884

No longer available, replaced with V03263

Weather Strip, 1/2" Pile

V2493

| Length | Color | PN |
|---------------------|-------|----------|
| 500' (152,400) roll | Black | 11209999 |



Bi-Parting Meeting Stile Weather Strip

V2968

| Length | Color | PN |
|-------------|-------|----------|
| 144" (3658) | Black | 16219265 |

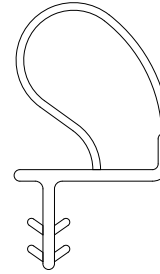

Jamb Bulb Weather Strip

V2475

| Length | Color | PN |
|-------------|-------|----------|
| 144" (3658) | Black | 11209699 |

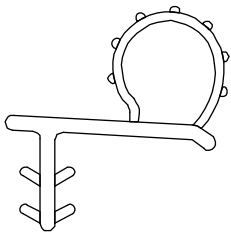

Weather Strip, Head Jamb

V2977

| Length | Color | PN |
|-------------|-------|----------|
| 200" (5080) | Black | 16219275 |

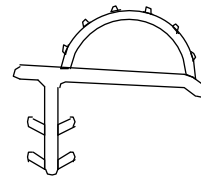

Sill Bulb Weather Strip

V2564

| Length | Color | PN |
|-------------|-------|----------|
| 150" (3810) | Black | 11211299 |

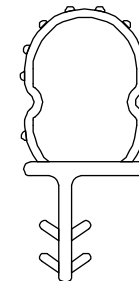

| | | Left Hand Screen | Right Hand Screen |
|---------------|-----------------|------------------------------|------------------------------|
| Single Screen | Inside Building | <p>Inside</p> <p>Outside</p> | <p>Inside</p> <p>Outside</p> |
| Double Screen | Inside Building | <p>Inside</p> <p>Outside</p> | |

To order full unit sill covers and screen cartridges, refer to configured parts in OMS.

When ordering replacement screen parts, specify:

1. Original order number/line number.

NOTE: Single screens: Marvin order number is found under the bottom stile cover on the opposite side of the tensioning springs. Double screens: Marvin order number is found under the bottom left hand stile cover on the opposite side of the tensioning springs (left hand when viewing from exterior).

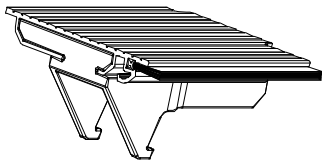

Sill Cover, Short End

| Operation | Color | PN |
|-----------|----------------|----------|
| LH | Clear Anodized | 10504034 |
| | Gunmetal | 10504036 |
| | Stone White | 10504038 |
| | Bronze | 10504040 |
| | Ebony | 10504042 |
| RH | Clear Anodized | 10504035 |
| | Gunmetal | 10504037 |
| | Stone White | 10504039 |
| | Bronze | 10504041 |
| | Ebony | 10504043 |

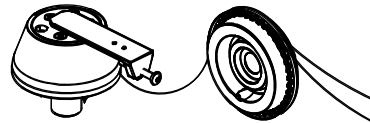

Cone Assembly

| Operation | PN |
|-----------|----------|
| LH | 10504102 |
| RH | 10504103 |

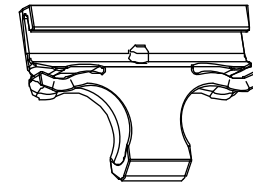

Screen Stop, Header, Bi-Parting

| PN |
|----------|
| 10504106 |

When ordering replacement screen parts, specify:

1. Original order number/line number.

NOTE: Single screens: Marvin order number is found under the bottom stile cover on the opposite side of the tensioning springs. Double screens: Marvin order number is found under the bottom left hand stile cover on the opposite side of the tensioning springs (left hand when viewing from exterior).

Illustration not available

Cable

| Color | PN |
|--------|----------|
| Black | 10504098 |
| Red | 10504099 |
| Yellow | 10504100 |
| Green | 10504101 |



Splice Joiner

| PN |
|----------|
| 10504139 |

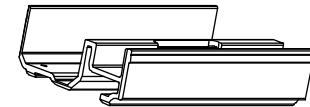

Splice Joiner, Sill

| PN |
|----------|
| 10504175 |

When ordering replacement aluminum parts, specify:

1. Original order number/line number;
2. Total rough opening;
3. Part length;
4. Handing;
5. Finish/Color (where applicable),

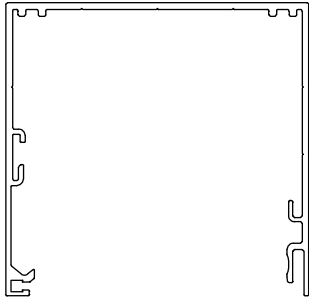

Head Jamb Frame
Head Jamb Frame, Spliced

Note: Spliced is available in LH or RH configurations

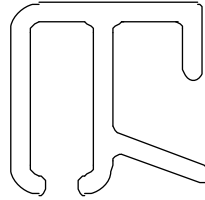

Tab Retainer, Head Jamb

Includes: Retainer clips



Cover, Head Jamb
Cover, Head Jamb, Spliced

Includes: Pile weather strip and retainer clips

Note: Spliced is available in LH or RH configurations.



Sill Cover, Spliced

Includes: Pile weather strip and end caps

Note: Available in LH or RH configurations

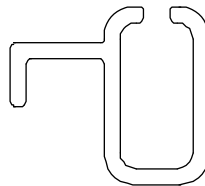

Tab Retainer, Sill
Tab Retainer, Sill, Spliced

Note: Spliced is available in LH or RH configurations.

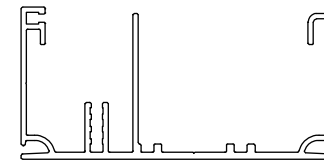

Sill, Frame
Sill, Spliced

Note: Spliced is available in LH or RH configurations

When ordering replacement aluminum parts, specify:

1. Original order number/line number;
2. Total rough opening;
3. Part length;
4. Handing;
5. Finish (where applicable),

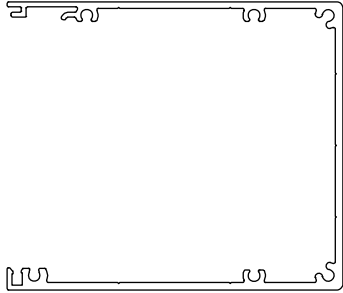

Frame, Jamb, No Cartridge
Jamb, Cartridge Side
Jamb, Bi-Parting

Note: Available in LH or RH configurations

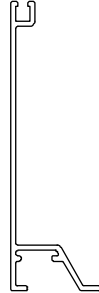

Jamb Cover, Cartridge

Includes: Pile weather strip and retainer clips



Jamb Cover, Stationary

Includes: Magnets and retainer clips

When ordering replacement aluminum parts, specify:

1. Original order number/line number;

NOTE: Single screens: Marvin order number is found under the bottom stile cover on the opposite side of the tensioning springs. Double screens: Marvin order number is found under the bottom left hand stile cover on the opposite side of the tensioning springs (left hand when viewing screen from exterior).

Top Cartridge Bearing

Includes:

- 1 - Cable tensioner
- 1 - Top block slide pulley/bearing
- 4 - Screws

Product usage:

Used prior to 04/27/2020

| Operation | Color | PN |
|-----------|-------|----------|
| LH | Black | 10501287 |
| RH | Black | 10501288 |



Bottom Handle Pull Assembly

Includes:

- 1 - Bottom stile cap
- 2 - Screws/cable crimp

Product usage:

Used prior to 04/27/2020

| Operation | Color | PN |
|-----------|-------|----------|
| LH | Black | 10501289 |
| RH | Black | 10501290 |



When ordering replacement aluminum parts, specify:

1. Original order number/line number;

NOTE: Single screens: Marvin order number is found under the bottom stile cover on the opposite side of the tensioning springs. Double screens: Marvin order number is found under the bottom left hand stile cover on the opposite side of the tensioning springs (left hand when viewing screen from exterior).

Top Handle Pull Assembly

Includes:

- 1 - Top stile cap
- 2 - Screws/cable crimp

Product usage:

Used prior to 04/27/2020

| Operation | Color | PN |
|-----------|-------|----------|
| LH | Black | 10501291 |
| RH | Black | 10501292 |



Bi-Parting Screen Stop

Includes:

- 1 - Double screen stop

Product usage:

Used prior to 04/27/2020

| Color | PN |
|-------|----------|
| Black | 10501296 |



When ordering replacement aluminum parts, specify:

1. Original order number/line number;

NOTE: Single screens: Marvin order number is found under the bottom stile cover on the opposite side of the tensioning springs. Double screens: Marvin order number is found under the bottom left hand stile cover on the opposite side of the tensioning springs (left hand when viewing screen from exterior).

Bottom Cartridge Bearing

Includes:

- 1 - Bottom bearing/pulley assembly
- 2 - Screws

Product usage:

Used prior to 04/27/2020

| Operation | PN |
|-----------|----------|
| LH | 10501299 |
| RH | 10501298 |



Spool Kit

Includes:

- 1 - LH/RH Cone
- 1 - Cable/crimp
- 1 - Cable connector
- 4 - Screws

NOTE: Modern MultiSlide Door will use 13ft (cable) for each cone to connector. Top Cables: width of screen + 1/2 the height. Bottom Cables: 2 times the width of the screen + 1 1/2 times the height

Product usage:

Used prior to 04/27/2020

| Length | Operation | Color | PN |
|-------------------|-----------|-------|----------|
| Specify LF length | LH | Black | 10501294 |
| | RH | Gray | 10501293 |



When ordering replacement aluminum parts, specify:

1. Original order number/line number;

NOTE: Single screens: Marvin order number is found under the bottom stile cover on the opposite side of the tensioning springs. Double screens: Marvin order number is found under the bottom left hand stile cover on the opposite side of the tensioning springs (left hand when viewing screen from exterior).

Cable

NOTE: Modern MultiSlide Door will use 13ft (cable) for each cone to connector. Top Cables: width of screen + 1/2 the height. Bottom Cables: 2 times the width of the screen + 1 1/2 times the height

Product usage:

Used prior to 04/27/2020

| Length | PN |
|-------------------|----------|
| Specify LF length | 10501259 |



Handle Pull Covers/Spring Kit

Includes:

- 4 - Stile covers
- 2 - Springs
- 4 - Spring keepers

Product usage:

Used prior to 04/27/2020

| PN |
|----------|
| 10501297 |



When ordering replacement aluminum parts, specify:

1. Original order number/line number;
2. Total rough opening;
3. Part length;
4. Handing;
5. Finish/color (where applicable),

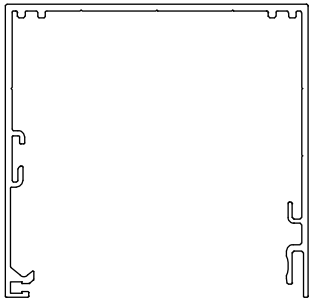

Head Jamb Frame

Includes: Weather strip
Used prior to 04/27/2020

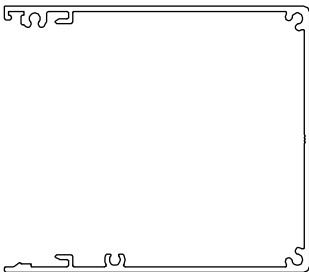

Jamb Frame

Includes: Weather strip
Used prior to 04/27/2020

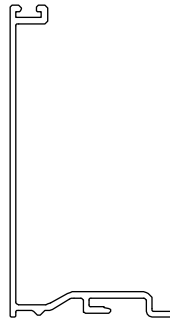

Head Jamb/Jamb Cover

Includes: Weather strip
Used prior to 04/27/2020

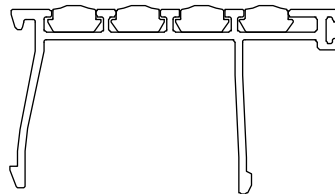

Sill

Includes: Weather strip
Used prior to 04/27/2020



Cartridge

Includes: 1 Complete cartridge assembly
Used prior to 04/27/2020

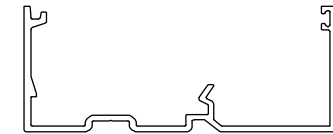

Sill

Includes: Weather strip
Used prior to 04/27/2020



Jamb Stop

Includes: Magnet strip
Used prior to 04/27/2020