

Ultimate Awning Push Out Seryery

Supplemental Installation Instructions

ABSTRACT: This instruction is intended to be a supplement to the Marvin Wood or Clad window installation instructions and focus on specific fastening locations for the Seryery window. This instruction is relevant for product produced October 2022 to present.

WARNING!

Always practice safety! Wear the appropriate eye, ear, and hand protection, especially when working with power tools.

Seek Assistance

Some large windows and/or assemblies are very heavy. Avoid injury by getting help to lift and position the unit into the rough opening.

Table of Contents

Tools Needed	1	Structural Fastening	3
Parts Supplied	1	Operation	4
Removing Interior Covers	2	Final Steps	4

Tools Needed

- Flat bar
- Drill/driver with #2 Phillips head

Parts Supplied

- #8 x 3" Installation screws (quantity varies with window size)
- #10 x 3" installation screws (quantity varies with window size)

WARNING!

Older homes may contain lead-based paint, which may be disturbed when replacing windows or performing renovations. Consult state or local authorities for safe handling, disposal, or abatement requirements. For information, go to www.epa.gov/lead.

CAUTION!

Wear gloves and protective clothing when handling the frame components. Some high-density fiberglass surfaces are not coated and can leave splinters in bare skin.

Removing Interior Covers

You will want to remove the interior covers to access fastener locations. Once removed, set aside for reuse.

1. Use a thin flat bar to pry the bottom cover up and release from the vinyl barb.



Figure 1

2. Remove the top cover in the same manner.

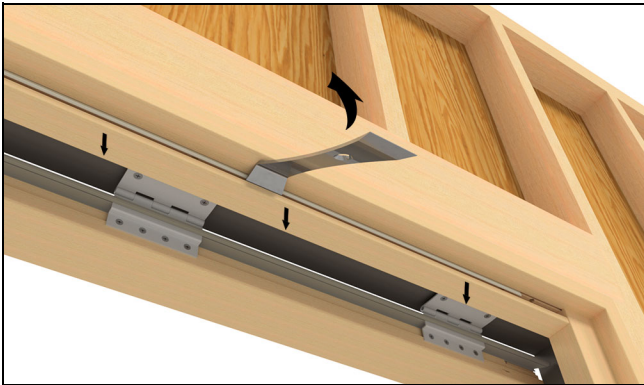

Figure 2

3. Remove the side jambs covers.

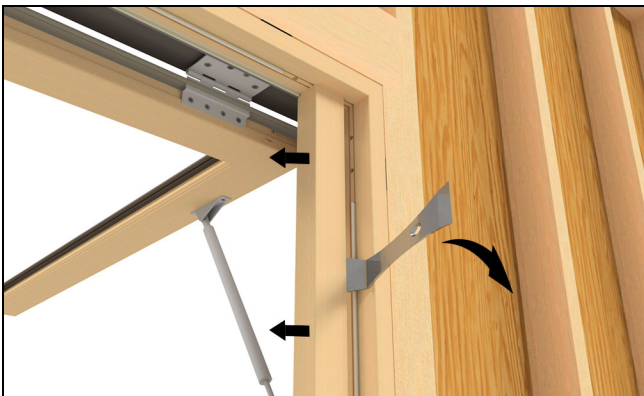

Figure 3

Structural Fastening

After you have installed the window according to the wood or clad window instructions and the window is level, plumb and square in the opening, use the following steps to complete the structural fastening of the servery window.

IMPORTANT

When fastening and shimming through the frame into the rough opening, be sure not to over-shim which can bow or distort the jamb.

1. Drive #8 x 3" installation screws through the pre-drilled installation holes in the jambs and head jamb, into the rough opening. Be sure to shim near each fastener.

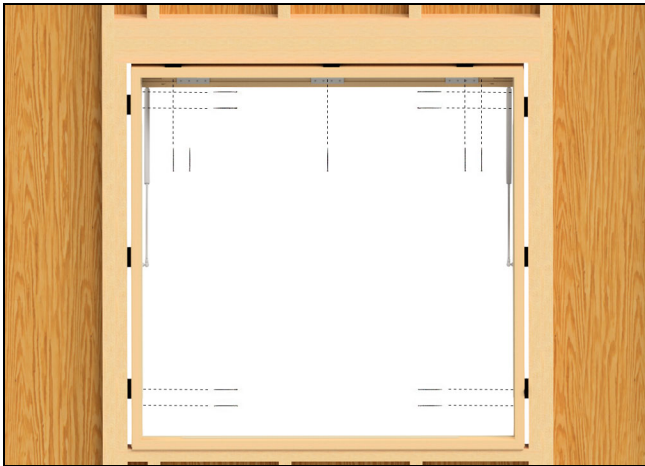

Figure 4

2. Drive #10 x 3" installation screws through the top screw hole in the gas strut base (attached to the frame). Be sure to shim near the fastener.

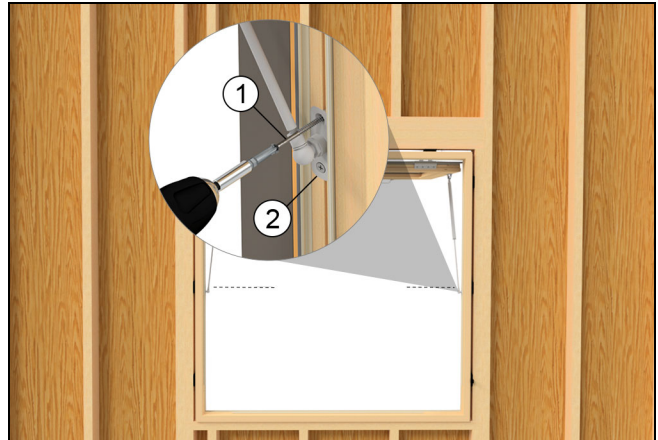

Figure 5

1	#10 x 3" installation screw
2	Gas strut base

3. Drive one installation screw into the rough opening head jamb through the butt hinges.

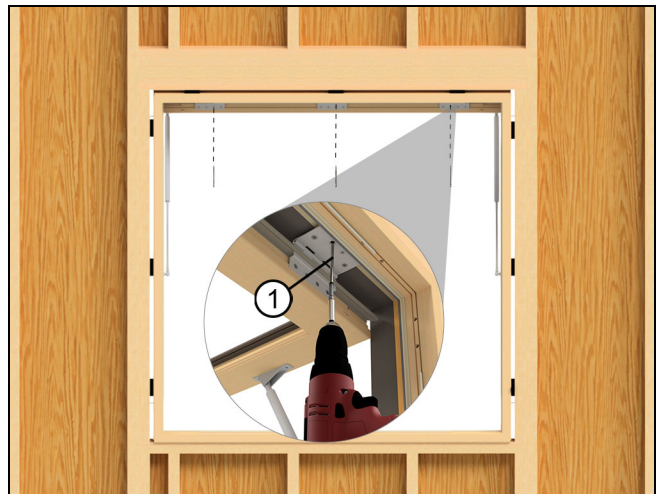

Figure 6

1	#10 x 3" Installation screw
---	-----------------------------

Operation

1. Turn the handle up to unlock.

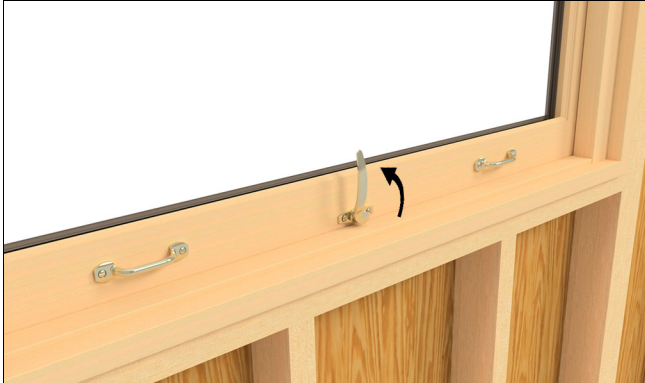

Figure 7

2. Push the window open until the gas struts engage and open the sash the rest of the way.



Figure 8

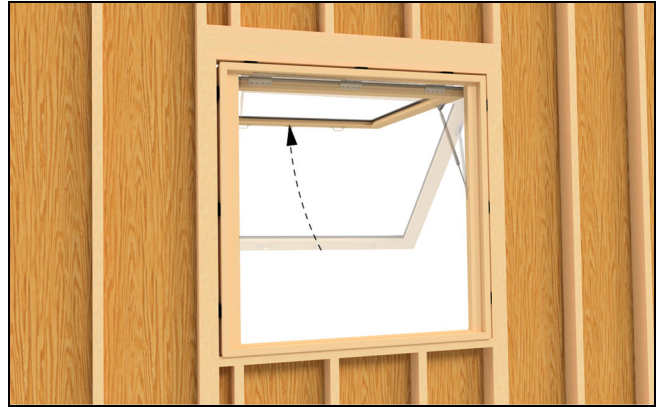

Figure 9

3. To close the sash, use the sash lift to pull the sash shut and then turn the handle down to lock.

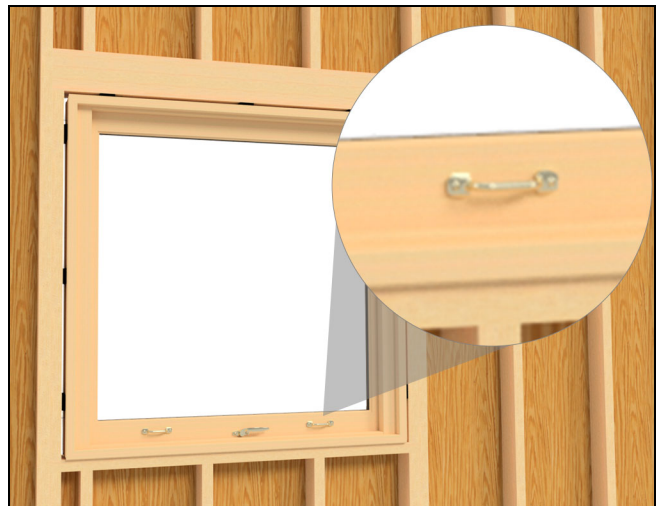

Figure 10

Final Steps

1. Test the window for proper operation. You may need to adjust screws and shims if you have distorted any frame members.
2. Replace the interior stops.
3. Follow the clad or wood window installation instructions for final installation details, flashing and sealing details.

ATTENTION

Sash removal is not recommended.
